



PE 100 SPOJNI ELEMENTI ZA PE CIJEVNE SUSTAVE

ELEKTRO SPOJNICA, PE100, SDR11 (PN16)



ŠIFRA	OPIS	JM	RAB	€/JM	KN/JM
PE10EM20	EL. SPOJNICA D20, SDR11	KOM	HYF	3,26	24,52
PE10EM25	EL. SPOJNICA D25, SDR11	KOM	HYF	3,29	24,78
PE10EM32	EL. SPOJNICA D32, SDR11	KOM	HYF	3,37	25,37
PE10EM40	EL. SPOJNICA D40, SDR11	KOM	HYF	4,01	30,18
PE10EM50	EL. SPOJNICA D50, SDR11	KOM	HYF	4,63	34,85
PE10EM63	EL. SPOJNICA D63, SDR11	KOM	HYF	4,72	35,56
PE10EM75	EL. SPOJNICA D75, SDR11	KOM	HYF	8,48	63,89
PE10EM90	EL. SPOJNICA D90, SDR11	KOM	HYF	8,97	67,57
PE10EM110	EL. SPOJNICA D110, SDR11	KOM	HYF	11,33	85,34
PE10EM125	EL. SPOJNICA D125, SDR11	KOM	HYF	14,95	112,60
PE10EM140	EL. SPOJNICA D140, SDR11	KOM	HYF	26,18	197,23
PE10EM160	EL. SPOJNICA D160, SDR11	KOM	HYF	26,38	198,69
PE10EM180	EL. SPOJNICA D180, SDR11	KOM	HYF	32,75	246,68
PE10EM200	EL. SPOJNICA D200, SDR11	KOM	HYF	37,00	278,74
PE10EM225	EL. SPOJNICA D225, SDR11	KOM	HYF	56,64	426,69
PE10EM250	EL. SPOJNICA D250, SDR11	KOM	HYF	81,80	616,32
PE10EM280	EL. SPOJNICA D280, SDR11	KOM	HYF	124,40	937,28
PE10EM315	EL. SPOJNICA D315, SDR11	KOM	HYF	152,25	1.147,07
PE10EM355	EL. SPOJNICA D355, SDR11	KOM	HYF	257,89	1.943,07
PE10EM400	EL. SPOJNICA D400, SDR11	KOM	HYF	334,16	2.517,67
PE10EM450	EL. SPOJNICA D450, SDR11	KOM	HYF	828,38	6.241,41
PE10EM500	EL. SPOJNICA D500, SDR11	KOM	HYF	1.099,13	8.281,39
PE10EM560	EL. SPOJNICA D560, SDR11	KOM	HYF	1.402,30	10.565,59
PE10EM630	EL. SPOJNICA D630, SDR11	KOM	HYF	1.845,18	13.902,48

ELEKTRO SPOJNICA, PE100, SDR17



ŠIFRA	OPIS	JM	RAB	€/JM	KN/JM
PE10EM160PN10	Nije u ponudi - koristiti SDR11	KOM	HYF	na upit	na upit
PE10EM180PN10	Nije u ponudi - koristiti SDR11	KOM	HYF	na upit	na upit
PE10EM200PN10	Nije u ponudi - koristiti SDR11	KOM	HYF	na upit	na upit
PE10EM225PN10	Nije u ponudi - koristiti SDR11	KOM	HYF	na upit	na upit
PE10EM250PN10	Nije u ponudi - koristiti SDR11	KOM	HYF	na upit	na upit
PE10EM280PN10	EL. SPOJNICA D280, SDR17	KOM	HYF	118,17	890,33
PE10EM315PN10	EL. SPOJNICA D315, SDR17	KOM	HYF	152,25	1.147,07
PE10EM355PN10	EL. SPOJNICA D355, SDR17	KOM	HYF	237,25	1.787,56
PE10EM400PN10	EL. SPOJNICA D400, SDR17	KOM	HYF	307,41	2.316,17
PE10EM450PN10	EL. SPOJNICA D450, SDR17	KOM	HYF	na upit	na upit
PE10EM500PN10	EL. SPOJNICA D500, SDR17	KOM	HYF	na upit	na upit
PE10EM560PN10	EL. SPOJNICA D560, SDR17	KOM	HYF	na upit	na upit
PE10EM630PN10	EL. SPOJNICA D630, SDR17	KOM	HYF	na upit	na upit

ELEKTRO KOLJENO / 90°, PE100, SDR 11



ŠIFRA	OPIS	JM	RAB	€/JM	KN/JM
PE10EW20/90	EL. KOLJENO D20/90°, SDR11	KOM	HYG	6,04	45,45
PE10EW25/90	EL. KOLJENO D25/90°, SDR11	KOM	HYG	7,12	53,64
PE10EW32/90	EL. KOLJENO D32/90°, SDR11	KOM	HYG	7,20	54,24
PE10EW40/90	EL. KOLJENO D40/90°, SDR11	KOM	HYG	7,43	55,93
PE10EW50/90	EL. KOLJENO D50/90°, SDR11	KOM	HYG	8,31	62,58
PE10EW63/90	EL. KOLJENO D63/90°, SDR11	KOM	HYG	14,58	109,84
PE10EW75/90	EL. KOLJENO D75/90°, SDR11	KOM	HYG	18,36	138,31
PE10EW90/90	EL. KOLJENO D90/90°, SDR11	KOM	HYG	19,39	146,02
PE10EW110/90	EL. KOLJENO D110/90°, SDR11	KOM	HYG	25,81	194,45
PE10EW125/90	EL. KOLJENO D125/90°, SDR11	KOM	HYG	35,11	264,48
PE10EW140/90	EL. KOLJENO D140/90°, SDR11	KOM	HYG	67,34	507,35
PE10EW160/90	EL. KOLJENO D160/90°, SDR11	KOM	HYG	70,13	528,35
PE10EW180/90	EL. KOLJENO D180/90°, SDR11	KOM	HYG	115,15	867,59
PE10EW200/90	EL. KOLJENO D200/90°, SDR11	KOM	HYG	160,25	1.207,37



PE 100 SPOJNI ELEMENTI ZA PE CIJEVNE SUSTAVE

ELEKTRO KOLJENO / 45°, PE100, SDR 11



ŠIFRA	OPIS	JM	RAB	€/JM	KN/JM
PE10EW25/45	EL. KOLJENO D25/45°, SDR11	KOM	HYG	6,50	48,93
PE10EW32/45	EL. KOLJENO D32/45°, SDR11	KOM	HYG	6,50	48,93
PE10EW40/45	EL. KOLJENO D40/45°, SDR11	KOM	HYG	7,15	53,83
PE10EW50/45	EL. KOLJENO D50/45°, SDR11	KOM	HYG	8,16	61,47
PE10EW63/45	EL. KOLJENO D63/45°, SDR11	KOM	HYG	10,12	76,22
PE10EW75/45	EL. KOLJENO D75/45°, SDR11	KOM	HYG	18,03	135,84
PE10EW90/45	EL. KOLJENO D90/45°, SDR11	KOM	HYG	19,04	143,42
PE10EW110/45	EL. KOLJENO D110/45°, SDR11	KOM	HYG	25,81	194,45
PE10EW125/45	EL. KOLJENO D125/45°, SDR11	KOM	HYG	35,11	264,48
PE10EW140/45	EL. KOLJENO D140/45°, SDR11	KOM	HYG	67,34	507,36
PE10EW160/45	EL. KOLJENO D160/45°, SDR11	KOM	HYG	70,13	528,36
PE10EW180/45	EL. KOLJENO D180/45°, SDR11	KOM	HYG	115,16	867,62
PE10EW200/45	EL. KOLJENO D200/45°, SDR11	KOM	HYG	160,25	1.207,38

ELEKTRO T-KOMAD, PE100, SDR11



ŠIFRA	OPIS	JM	RAB	€/JM	KN/JM
PE10ET20	EL. T-KOMAD EGAL, D20MM, SDR11	KOM	HYG	7,84	59,01
PE10ET25	EL. T-KOMAD EGAL, D25MM, SDR11	KOM	HYG	8,16	61,47
PE10ET32	EL. T-KOMAD EGAL, D32MM, SDR11	KOM	HYG	8,27	62,29
PE10ET40	EL. T-KOMAD EGAL, D40MM, SDR11	KOM	HYG	9,63	72,53
PE10ET50	EL. T-KOMAD EGAL, D50MM, SDR11	KOM	HYG	10,53	79,30
PE10ET63	EL. T-KOMAD EGAL, D63MM, SDR11	KOM	HYG	10,91	82,16
PE10ET75	EL. T-KOMAD EGAL, D75MM, SDR11	KOM	HYG	18,74	141,16
PE10ET90	EL. T-KOMAD EGAL, D90MM, SDR11	KOM	HYG	19,09	143,83
PE10ET110	EL. T-KOMAD EGAL, D110MM, SDR11	KOM	HYG	34,16	257,32
PE10ET125	EL. T-KOMAD EGAL, D125MM, SDR11	KOM	HYG	45,01	339,08
PE10ET140	EL. T-KOMAD EGAL, D140MM, SDR11	KOM	HYG	70,85	533,77
PE10ET160	EL. T-KOMAD EGAL, D160MM, SDR11	KOM	HYG	90,30	680,35
PE10ET180	EL. T-KOMAD EGAL, D180MM, SDR11	KOM	HYG	122,75	924,83
PE10ET200	EL. T-KOMAD EGAL, D200MM, SDR11	KOM	HYG	na upit	na upit

ELEKTRO T-KOMAD REDUCIRANI, PE100, SDR11



ŠIFRA	OPIS	JM	RAB	€/JM	KN/JM
PE10ET63/40	EL. T-KOMAD RED. D63/40, SDR 11	KOM	HYG	9,89	74,51
PE10ET63/50	EL. T-KOMAD RED. D63/50, SDR 11	KOM	HYG	9,94	74,88
PE10ET90/63	EL. T-KOMAD RED. D90/63, SDR 11	KOM	HYG	14,84	111,75
PE10ET110/63	EL. T-KOMAD RED. D110/63, SDR 11	KOM	HYG	27,27	205,44
PE10ET110/90	EL. T-KOMAD RED. D110/90, SDR 11	KOM	HYG	31,08	234,12
PE10ET125/90	EL. T-KOMAD RED. D125/90, SDR 11	KOM	HYG	44,50	335,25
PE10ET125/110	EL. T-KOMAD RED. D125/110, SDR 11	KOM	HYG	104,69	788,77
PE10ET160/63	EL. T-KOMAD RED. D160/63, SDR 11	KOM	HYG	198,01	1.491,87
PE10ET160/90	EL. T-KOMAD RED. D160/90, SDR 11	KOM	HYG	198,01	1.491,87
PE10ET160/110	EL. T-KOMAD RED. D160/110, SDR 11	KOM	HYG	198,01	1.491,87
PE10ET160/125	EL. T-KOMAD RED. D160/125, SDR 11	KOM	HYG	198,01	1.491,87
PE10ET180/125	EL. T-KOMAD RED. D180/125, SDR 11	KOM	HYG	198,01	1.491,87

ELEKTRO REDUKCIJA, PE100, SDR11



ŠIFRA	OPIS	JM	RAB	€/JM	KN/JM
PE10ER25/20	EL. REDUKCIJA D25/20, SDR11	KOM	HYG	3,05	22,91
PE10ER32/20	EL. REDUKCIJA D32/20, SDR11	KOM	HYG	3,42	25,70
PE10ER32/25	EL. REDUKCIJA D32/25, SDR11	KOM	HYG	3,42	25,70
PE10ER40/20	EL. REDUKCIJA D40/20, SDR11	KOM	HYG	8,86	66,69
PE10ER40/25	EL. REDUKCIJA D40/25, SDR11	KOM	HYG	8,86	66,69
PE10ER40/32	EL. REDUKCIJA D40/32, SDR11	KOM	HYG	4,95	37,25
PE10ER50/32	EL. REDUKCIJA D50/32, SDR11	KOM	HYG	4,95	37,25
PE10ER50/40	EL. REDUKCIJA D50/40, SDR11	KOM	HYG	4,95	37,25
PE10ER63/32	EL. REDUKCIJA D63/32, SDR11	KOM	HYG	6,28	47,31
PE10ER63/40	EL. REDUKCIJA D63/40, SDR11	KOM	HYG	6,51	48,99
PE10ER63/50	EL. REDUKCIJA D63/50, SDR11	KOM	HYG	7,42	55,88
PE10ER75/63	EL. REDUKCIJA D75/63, SDR11	KOM	HYG	14,84	111,75
PE10ER90/50	EL. REDUKCIJA D90/50, SDR11	KOM	HYG	15,50	116,78
PE10ER90/63	EL. REDUKCIJA D90/63, SDR11	KOM	HYG	15,50	116,78
PE10ER90/75	EL. REDUKCIJA D90/75, SDR11	KOM	HYG	15,50	116,78
PE10ER110/63	EL. REDUKCIJA D110/63, SDR11	KOM	HYG	23,07	173,78



PE 100 SPOJNI ELEMENTI ZA PE CIJEVNE SUSTAVE

ELEKTRO REDUKCIJA, PE100, SDR11

ŠIFRA	OPIS	JM	RAB	€/JM	KN/JM
PE10ER110/90	EL. REDUKCIJA D110/90, SDR11	KOM	HYG	23,99	180,71
PE10ER125/90	EL. REDUKCIJA D125/63, SDR11	KOM	HYG	25,54	192,40
PE10ER125/110	EL. REDUKCIJA D125/110 SDR11	KOM	HYG	25,54	192,40
PE10ER160/90	EL. REDUKCIJA D160/90, SDR11	KOM	HYG	40,10	302,11
PE10ER160/110	EL. REDUKCIJA D160/110, SDR11	KOM	HYG	40,10	302,11
PE10ER160/125	EL. REDUKCIJA D160/125, SDR11	KOM	HYG	51,32	386,61

ELEKTRO KAPA, PE100, SDR11

ŠIFRA	OPIS	JM	RAB	€/JM	KN/JM
PE10EK20	EL. KAPA D20, SDR11	KOM	HYG	4,75	35,76
PE10EK25	EL. KAPA D25, SDR11	KOM	HYG	5,11	38,45
PE10EK32	EL. KAPA D32, SDR11	KOM	HYG	5,31	39,95
PE10EK40	EL. KAPA D40, SDR11	KOM	HYG	5,94	44,71
PE10EK50	EL. KAPA D50, SDR11	KOM	HYG	7,57	56,99
PE10EK63	EL. KAPA D63, SDR11	KOM	HYG	7,72	58,12
PE10EK75	EL. KAPA D75, SDR11	KOM	HYG	14,84	111,75
PE10EK90	EL. KAPA D90, SDR11	KOM	HYG	17,45	131,42
PE10EK110	EL. KAPA D110, SDR11	KOM	HYG	23,68	178,35
PE10EK125	EL. KAPA D125, SDR11	KOM	HYG	34,00	256,11
PE10EK140	EL. KAPA D140, SDR11	KOM	HYG	48,60	366,11
PE10EK160	EL. KAPA D160, SDR11	KOM	HYG	53,40	402,31
PE10EK180	EL. KAPA D180, SDR11	KOM	HYG	74,17	558,76
PE10EK200	EL. KAPA D200, SDR11	KOM	HYG	92,02	693,30
PE10EK225	EL. KAPA D225, SDR11	KOM	HYG	114,12	859,81
PE10EK250	EL. KAPA D250, SDR11	KOM	HYG	133,49	1.005,75



ELEKTRO OBUJMICA/ODVOJAK S NOŽEM, MONOBLOC, PE100, SDR11 (za bušenje pod tlakom)

ŠIFRA	OPIS	JM	RAB	€/JM	KN/JM
PE10EAS63/20MONO	EL. OBUJM. /ODV. D63/20 MONOBLOK, SDR11	KOM	HYG	19,39	146,02
PE10EAS63/25MONO	EL. OBUJM. /ODV. D63/25 MONOBLOK, SDR11	KOM	HYG	19,39	146,02
PE10EAS63/32MONO	EL. OBUJM. /ODV. D63/32 MONOBLOK, SDR11	KOM	HYG	19,39	146,02
PE10EAS75/20MONO	EL. OBUJM. /ODV. D75/20 MONOBLOK, SDR11	KOM	HYG	19,39	146,02
PE10EAS75/25MONO	EL. OBUJM. /ODV. D75/25 MONOBLOK, SDR11	KOM	HYG	19,39	146,02
PE10EAS75/32MONO	EL. OBUJM. /ODV. D75/32 MONOBLOK, SDR11	KOM	HYG	19,39	146,02
PE10EAS90/20MONO	EL. OBUJM. /ODV. D90/20 MONOBLOK, SDR11	KOM	HYG	19,39	146,02
PE10EAS90/25MONO	EL. OBUJM. /ODV. D90/25 MONOBLOK, SDR11	KOM	HYG	19,39	146,02
PE10EAS90/32MONO	EL. OBUJM. /ODV. D90/32 MONOBLOK, SDR11	KOM	HYG	19,39	146,02
PE10EAS110/20MONO	EL. OBUJM. /ODV. D110/20 MONOBLOK, SDR11	KOM	HYG	20,74	156,20
PE10EAS110/25MONO	EL. OBUJM. /ODV. D110/25 MONOBLOK, SDR11	KOM	HYG	20,74	156,20
PE10EAS110/32MONO	EL. OBUJM. /ODV. D110/32 MONOBLOK, SDR11	KOM	HYG	20,74	156,20
PE10EAS125/20MONO	EL. OBUJM. /ODV. D125/20 MONOBLOK, SDR11	KOM	HYG	20,74	156,20
PE10EAS125/25MONO	EL. OBUJM. /ODV. D125/25 MONOBLOK, SDR11	KOM	HYG	20,74	156,20
PE10EAS125/32MONO	EL. OBUJM. /ODV. D125/32 MONOBLOK, SDR11	KOM	HYG	20,74	156,20
PE10EAS160/20MONO	EL. OBUJM. /ODV. D160/20 MONOBLOK, SDR11	KOM	HYG	21,05	158,54
PE10EAS160/25MONO	EL. OBUJM. /ODV. D160/25 MONOBLOK, SDR11	KOM	HYG	21,05	158,54
PE10EAS160/32MONO	EL. OBUJM. /ODV. D160/32 MONOBLOK, SDR11	KOM	HYG	21,05	158,54
PE10EAS180/20MONO	EL. OBUJM. /ODV. D180/20 MONOBLOK, SDR11	KOM	HYG	21,05	158,54
PE10EAS180/25MONO	EL. OBUJM. /ODV. D180/25 MONOBLOK, SDR11	KOM	HYG	21,05	158,54
PE10EAS180/32MONO	EL. OBUJM. /ODV. D180/32 MONOBLOK, SDR11	KOM	HYG	21,05	158,54



ELEKTRO OBUJMICA ZA BALONIRANJE, PE100, SDR11

ŠIFRA	OPIS	JM	RAB	€/JM	KN/JM
PE10EBLASCH110	EL. OBUJM./BALON. D110 BU · 56MM,SDR11	KOM	HYG	74,35	560,19
PE10EBLASCH125	EL. OBUJM./BALON. D125 BU · 56MM,SDR11	KOM	HYG	80,85	609,13
PE10EBLASCH140	EL. OBUJM./BALON. D140 BU · 56MM,SDR11	KOM	HYG	91,37	688,38
PE10EBLASCH160	EL. OBUJM./BALON. D160 BU · 56MM,SDR11	KOM	HYG	91,37	688,38



KUGLASTA SLAVINA, PE100, SDR11

ŠIFRA	OPIS	JM	RAB	€/JM	KN/JM
PE10KS32	PE-KUGL. SLAVINA, D32, SDR11	KOM	HYG	50,01	376,79
PE10KS40	PE-KUGL. SLAVINA, D40, SDR11	KOM	HYG	76,64	577,38
PE10KS63	PE-KUGL. SLAVINA, D63, SDR11	KOM	HYG	84,57	637,17
PE10KS90	PE-KUGL. SLAVINA, D90, SDR11	KOM	HYG	141,45	1.065,73
PE10KS110	PE-KUGL. SLAVINA, D110, SDR11	KOM	HYG	217,54	1.639,01
PE10KS125	PE-KUGL. SLAVINA, D125, SDR11	KOM	HYG	223,87	1.686,69





PE 100 SPOJNI ELEMENTI ZA PE CIJEVNE SUSTAVE

PIPELIFE

CJENIK 01/2023

KUGLASTA SLAVINA, PE100, SDR11

ŠIFRA	OPIS	JM	RAB	€/JM	KN/JM
PE10KS160	PE-KUGL. SLAVINA, D160, SDR11	KOM	HYG	650,13	4.898,38
PE10KS180	PE-KUGL. SLAVINA, D180, SDR11	KOM	HYG	650,13	4.898,38



PRIJELAZNI KOMAD PE/MJED S VANJSKIM NAVOJEM, PE100, SDR11

ŠIFRA	OPIS	JM	RAB	€/JM	KN/JM
PE10EAG20/1/2	PRIJELAZ PE/MJED, 20/MS R1/2", SDR11	KOM	HYG	13,85	104,31
PE10EAG25/3/4	PRIJELAZ PE/MJED, 25/MS R3/4", SDR11	KOM	HYG	14,40	108,48
PE10EAG32/1	PRIJELAZ PE/MJED, 32/MS R1", SDR11	KOM	HYG	16,75	126,16
PE10EAG40/5/4	PRIJELAZ PE/MJED, 40/MS R5/4", SDR11	KOM	HYG	21,92	165,14
PE10EAG50/6/4	PRIJELAZ PE/MJED, 50/MS R6/4", SDR11	KOM	HYG	22,50	169,49
PE10EAG63/2	PRIJELAZ PE/MJED, 63/MS R2", SDR11	KOM	HYG	32,51	244,92
PE10EAG75/2/1/2	PRIJELAZ PE/MJED, 75/MS R2 1/2", SDR11	KOM	HYG	58,32	439,37
PE10EAG90/3	PRIJELAZ PE/MJED, 90/MS R3", SDR11	KOM	HYG	70,95	534,54
PE10EAG110/4	PRIJELAZ PE/MJED, 110/MS R4", SDR11	KOM	HYG	121,97	918,96
PE10EAG125/4	PRIJELAZ PE/MJED, 125/MS R4", SDR11	KOM	HYG	213,86	1.611,26

PRIJELAZNI KOMAD PE/MJED S UNUTARNJIM NAVOJEM, PE100, SDR11

ŠIFRA	OPIS	JM	RAB	€/JM	KN/JM
PE10EIG20/1/2	PRIJELAZ PE/MJED, 20/MS R1/2", SDR11	KOM	HXF	13,23	99,65
PE10EIG25/3/4	PRIJELAZ PE/MJED, 25/MS R3/4", SDR11	KOM	HXF	13,76	103,64
PE10EIG32/1	PRIJELAZ PE/MJED, 32/MS RP1", SDR11	KOM	HXF	16,46	123,97
PE10EIG40/5/4	PRIJELAZ PE/MJED, 40/MS RP5/4", SDR11	KOM	HXF	20,47	154,22
PE10EIG50/6/4	PRIJELAZ PE/MJED, 50/MS RP6/4", SDR11	KOM	HXF	23,39	176,20
PE10EIG63/2	PRIJELAZ PE/MJED, 63/MS RP2", SDR11	KOM	HXF	35,38	266,53
PE10EIG75/2/1/2	PRIJELAZ PE/MJED, 75/MS R2 1/2", SDR11	KOM	HXF	93,57	704,94
PE10EIG90/3	PRIJELAZ PE/MJED, 90/MS R3", SDR11	KOM	HXF	81,93	617,24
PE10EIG110/4	PRIJELAZ PE/MJED, 110/MS R4", SDR11	KOM	HXF	121,97	918,96
PE10EIG125/4	PRIJELAZ PE/MJED, 125/MS R4", SDR11	KOM	HXF	218,16	1.643,66



PRIJELAZNI KOMAD PE/ČELIK S VANJSKIM NAVOJEM

ŠIFRA	OPIS	JM	RAB	€/JM	KN/JM
PK25/3/4VN	PRIJEL.KOMAD PE D25MM - R3/4"; POC.	KOM	HYH	18,71	140,92
PK32/1VN	PRIJEL.KOMAD PE D32MM - R1"; POC.	KOM	HYH	19,76	148,83
PK40/5/4VN	PRIJEL.KOMAD PE D40MM - R5/4"; POC.	KOM	HYH	28,80	216,92
PK50/6/4VN	PRIJEL.KOMAD PE D50MM - R6/4"; POC.	KOM	HYH	31,53	237,50
PK63/2VN	PRIJEL.KOMAD PE D63MM - R2"; POC.	KOM	HYH	43,93	330,92
PK75/2/1/2VN	PRIJEL.KOMAD PE D75MM - R2 1/2"; POC.	KOM	HYH	50,02	376,83
PK90/3VN	PRIJEL.KOMAD PE D90MM - R3"; POC.	KOM	HYH	58,64	441,75
PK110/4VN	PRIJEL.KOMAD PE D110MM - R4"; POC.	KOM	HYH	70,61	532,00
PK125/4VN	PRIJEL.KOMAD PE D125MM - R4"; POC.	KOM	HYH	99,40	748,92



PRIJELAZNI KOMAD PE/ČELIK S UNUTARNJIM NAVOJEM

ŠIFRA	OPIS	JM	RAB	€/JM	KN/JM
PK25/3/4UN	PRIJEL.KOMAD PE D25MM - RP3/4"; POC.	KOM	HYH	21,23	159,92
PK32/1UN	PRIJEL.KOMAD PE D32MM - RP1"; POC.	KOM	HYH	23,33	175,75
PK40/5/4UN	PRIJEL.KOMAD PE D40MM - RP5/4"; POC.	KOM	HYH	19,91	150,00
PK50/6/4UN	PRIJEL.KOMAD PE D50MM - RP6/4"; POC.	KOM	HYH	35,31	266,00
PK63/2UN	PRIJEL.KOMAD PE D63MM - RP2"; POC.	KOM	HYH	49,81	375,25
PK75/2/1/2UN	PRIJEL.KOMAD PE D75MM - RP2 1/2"; POC.	KOM	HYH	59,69	449,67
PK90/3UN	PRIJEL.KOMAD PE D90MM - RP3"; POC.	KOM	HYH	68,51	516,17
PK110/4UN	PRIJEL.KOMAD PE D110MM - RP4"; POC.	KOM	HYH	85,11	641,25
PK125/4UN	PRIJEL.KOMAD PE D125MM - RP4"; POC.	KOM	HYH	118,11	889,83

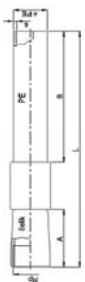

PRIJELAZNI KOMAD PE/ČELIK - PLIN

ŠIFRA	OPIS	JM	RAB	€/JM	KN/JM
PK25/20PLIN	PRIJEL. KOMAD PE100 D25MM - ČELIK NO20	KOM	HYH	12,17	91,67
PK32/25PLIN	PRIJEL. KOMAD PE100 D32MM - ČELIK NO25	KOM	HYH	12,84	96,67
PK40/32PLIN	PRIJEL. KOMAD PE100 D40MM - ČELIK NO32	KOM	HYH	26,28	198,00
PK50/40PLIN	PRIJEL. KOMAD PE100 D50MM - ČELIK NO40	KOM	HYH	21,93	165,17
PK63/50PLIN	PRIJEL. KOMAD PE100 D63MM - ČELIK NO50	KOM	HYH	26,11	196,67
PK75/65PLIN	PRIJEL. KOMAD PE100 D75MM - ČELIK NO65	KOM	HYH	74,46	561,00
PK90/80PLIN	PRIJEL. KOMAD PE100 D90MM - ČELIK NO80	KOM	HYH	76,56	576,83
PK110/100PLIN	PRIJEL. KOMAD PE100 D110MM - ČELIK NO100	KOM	HYH	100,72	758,83
PK125/100PLIN	PRIJEL. KOMAD PE100 D125MM - ČELIK NO100	KOM	HYH	140,69	1.060,00
PK160/150PLIN	PRIJEL. KOMAD PE100 D160MM - ČELIK NO150	KOM	HYH	207,97	1.566,92

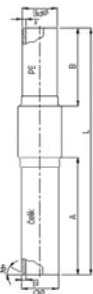



PE 100 SPOJNI ELEMENTI ZA PE CIJEVNE SUSTAVE

PEHD SPOJNI ELEMENTI ZA ELEKTROFUZIJSKO SPAJANJE

PE-KOLJENO 90°, SDR17

ŠIFRA	OPIS	JM	RAB	€/JM	KN/JM
PE10W63/90-10	KOLJENO PE100, D63/90°, SDR17	KOM	HXF	9,17	69,04
PE10W75/90-10	KOLJENO PE100, D75/90°, SDR17	KOM	HXF	10,61	79,91
PE10W90/90-10	KOLJENO PE100, D90/90°, SDR17	KOM	HXF	11,69	88,03
PE10W110/90-10	KOLJENO PE100, D110/90°, SDR17	KOM	HXF	22,18	167,08
PE10W125/90-10	KOLJENO PE100, D125/90°, SDR17	KOM	HXF	31,33	236,04
PE10W140/90-10	KOLJENO PE100, D140/90°, SDR17	KOM	HXF	43,16	325,14
PE10W160/90-10	KOLJENO PE100, D160/90°, SDR17	KOM	HXF	46,83	352,77
PE10W180/90-10	KOLJENO PE100, D180/90°, SDR17	KOM	HXF	54,93	413,82
PE10W200/90-10	KOLJENO PE100, D200/90°, SDR17	KOM	HXF	71,21	536,53
PE10W225/90-10	KOLJENO PE100, D225/90°, SDR17	KOM	HXF	95,29	717,96
PE10W250/90-10	KOLJENO PE100, D250/90°, SDR17	KOM	HXF	171,68	1.293,48
PE10W280/90-10	KOLJENO PE100, D280/90°, SDR17	KOM	HXF	312,82	2.356,92
PE10W315/90-10	KOLJENO PE100, D315/90°, SDR17	KOM	HXF	391,74	2.951,51
PE10W355/90-10	KOLJENO PE100, D355/90°, SDR17	KOM	HXF	683,37	5.148,85
PE10W400/90-10	KOLJENO PE100, D400/90°, SDR17	KOM	HXF	995,25	7.498,71
PE10W450/90-10	KOLJENO PE100, D450/90°, SDR17	KOM	HXF	1.372,12	10.338,20
PE10W500/90-10	KOLJENO PE100, D500/90°, SDR17	KOM	HXF	1.950,08	14.692,84

PE-KOLJENO 90°, SDR11

ŠIFRA	OPIS	JM	RAB	€/JM	KN/JM
PE10W20/90-16	KOLJENO PE100, D20/90°, SDR11	KOM	HXF	3,10	23,31
PE10W25/90-16	KOLJENO PE100, D25/90°, SDR11	KOM	HXF	3,20	24,07
PE10W32/90-16	KOLJENO PE100, D32/90°, SDR11	KOM	HXF	3,36	25,28
PE10W40/90-16	KOLJENO PE100, D40/90°, SDR11	KOM	HXF	3,56	26,78
PE10W50/90-16	KOLJENO PE100, D50/90°, SDR11	KOM	HXF	5,49	41,32
PE10W63/90-16	KOLJENO PE100, D63/90°, SDR11	KOM	HXF	9,17	69,08
PE10W75/90-16	KOLJENO PE100, D75/90°, SDR11	KOM	HXF	10,81	81,40
PE10W90/90-16	KOLJENO PE100, D90/90°, SDR11	KOM	HXF	11,97	90,15
PE10W110/90-16	KOLJENO PE100, D110/90°, SDR11	KOM	HXF	22,92	172,64
PE10W125/90-16	KOLJENO PE100, D125/90°, SDR11	KOM	HXF	34,49	259,81
PE10W140/90-16	KOLJENO PE100, D140/90°, SDR11	KOM	HXF	43,73	329,43
PE10W160/90-16	KOLJENO PE100, D160/90°, SDR11	KOM	HXF	50,53	380,71

PE-KOLJENO 90°, SDR11

ŠIFRA	OPIS	JM	RAB	€/JM	KN/JM
PE10W180/90-16	KOLJENO PE100, D180/90°, SDR11	KOM	HXF	64,59	486,64
PE10W200/90-16	KOLJENO PE100, D200/90°, SDR11	KOM	HXF	84,35	635,50
PE10W225/90-16	KOLJENO PE100, D225/90°, SDR11	KOM	HXF	101,58	765,29
PE10W250/90-16	KOLJENO PE100, D250/90°, SDR11	KOM	HXF	190,24	1.433,30
PE10W280/90-16	KOLJENO PE100, D280/90°, SDR11	KOM	HXF	410,73	3.094,58
PE10W315/90-16	KOLJENO PE100, D315/90°, SDR11	KOM	HXF	429,76	3.237,99
PE10W355/90-16	KOLJENO PE100, D355/90°, SDR11	KOM	HXF	963,39	7.258,61
PE10W400/90-16	KOLJENO PE100, D400/90°, SDR11	KOM	HXF	1.261,54	9.505,00
PE10W450/90-16	KOLJENO PE100, D450/90°, SDR11	KOM	HXF	1.735,14	13.073,37
PE10W500/90-16	KOLJENO PE100, D500/90°, SDR11	KOM	HXF	2.316,74	17.455,43

PE-KOLJENO 45°, SDR17

ŠIFRA	OPIS	JM	RAB	€/JM	KN/JM
PE10W63/45-10	KOLJENO PE100, D63/45°, SDR17	KOM	HXF	8,46	63,70
PE10W75/45-10	KOLJENO PE100, D75/45°, SDR17	KOM	HXF	9,32	70,17
PE10W90/45-10	KOLJENO PE100, D90/45°, SDR17	KOM	HXF	11,09	83,54
PE10W110/45-10	KOLJENO PE100, D110/45°, SDR17	KOM	HXF	21,52	162,14
PE10W125/45-10	KOLJENO PE100, D125/45°, SDR17	KOM	HXF	31,25	235,40
PE10W140/45-10	KOLJENO PE100, D140/45°, SDR17	KOM	HXF	39,46	297,30
PE10W160/45-10	KOLJENO PE100, D160/45°, SDR17	KOM	HXF	46,03	346,77
PE10W180/45-10	KOLJENO PE100, D180/45°, SDR17	KOM	HXF	53,73	404,82
PE10W200/45-10	KOLJENO PE100, D200/45°, SDR17	KOM	HXF	74,23	559,25
PE10W225/45-10	KOLJENO PE100, D225/45°, SDR17	KOM	HXF	90,78	683,91
PE10W250/45-10	KOLJENO PE100, D250/45°, SDR17	KOM	HXF	163,49	1.231,80
PE10W280/45-10	KOLJENO PE100, D280/45°, SDR17	KOM	HXF	297,98	2.245,12
PE10W315/45-10	KOLJENO PE100, D315/45°, SDR17	KOM	HXF	352,28	2.654,22
PE10W355/45-10	KOLJENO PE100, D355/45°, SDR17	KOM	HXF	616,71	4.646,59
PE10W400/45-10	KOLJENO PE100, D400/45°, SDR17	KOM	HXF	929,81	7.005,65
PE10W450/45-10	KOLJENO PE100, D450/45°, SDR17	KOM	HXF	1.251,63	9.430,40
PE10W500/45-10	KOLJENO PE100, D500/45°, SDR17	KOM	HXF	1.650,05	12.432,30



PE 100 SPOJNI ELEMENTI ZA PE CIJEVNE SUSTAVE

PE-KOLJENO 45°, SDR11



ŠIFRA	OPIS	JM	RAB	€/JM	KN/JM
PE10W20/45-16	KOLJENO PE100, D20/45°, SDR11	KOM	HXF	2,66	20,03
PE10W25/45-16	KOLJENO PE100, D25/45°, SDR11	KOM	HXF	3,09	23,22
PE10W32/45-16	KOLJENO PE100, D32/45°, SDR11	KOM	HXF	3,42	25,70
PE10W40/45-16	KOLJENO PE100, D40/45°, SDR11	KOM	HXF	3,56	26,78
PE10W50/45-16	KOLJENO PE100, D50/45°, SDR11	KOM	HXF	4,67	35,13
PE10W63/45-16	KOLJENO PE100, D63/45°, SDR11	KOM	HXF	8,81	66,32
PE10W75/45-16	KOLJENO PE100, D75/45°, SDR11	KOM	HXF	9,76	73,47
PE10W90/45-16	KOLJENO PE100, D90/45°, SDR11	KOM	HXF	12,23	92,11
PE10W110/45-16	KOLJENO PE100, D110/45°, SDR11	KOM	HXF	22,62	170,42
PE10W125/45-16	KOLJENO PE100, D125/45°, SDR11	KOM	HXF	34,35	258,74
PE10W140/45-16	KOLJENO PE100, D140/45°, SDR11	KOM	HXF	41,65	313,79
PE10W160/45-16	KOLJENO PE100, D160/45°, SDR11	KOM	HXF	48,16	362,84
PE10W180/45-16	KOLJENO PE100, D180/45°, SDR11	KOM	HXF	55,89	421,10
PE10W200/45-16	KOLJENO PE100, D200/45°, SDR11	KOM	HXF	76,31	574,94
PE10W225/45-16	KOLJENO PE100, D225/45°, SDR11	KOM	HXF	91,37	688,38
PE10W250/45-16	KOLJENO PE100, D250/45°, SDR11	KOM	HXF	183,48	1.382,36
PE10W280/45-16	KOLJENO PE100, D280/45°, SDR11	KOM	HXF	346,31	2.609,24
PE10W315/45-16	KOLJENO PE100, D315/45°, SDR11	KOM	HXF	369,41	2.783,27
PE10W355/45-16	KOLJENO PE100, D355/45°, SDR11	KOM	HXF	883,36	6.655,67
PE10W400/45-16	KOLJENO PE100, D400/45°, SDR11	KOM	HXF	1.246,61	9.392,55
PE10W450/45-16	KOLJENO PE100, D450/45°, SDR11	KOM	HXF	1.628,68	12.271,23
PE10W500/45-16	KOLJENO PE100, D500/45°, SDR11	KOM	HXF	2.192,12	16.516,47

PE-KOLJENO 30°, SDR17



ŠIFRA	OPIS	JM	RAB	€/JM	KN/JM
PE10W75/30-10	KOLJENO PE100, D75/30°, SDR17	KOM	HXF	36,42	274,38
PE10W90/30-10	KOLJENO PE100, D90/30°, SDR17	KOM	HXF	41,75	314,56
PE10W110/30-10	KOLJENO PE100, D110/30°, SDR17	KOM	HXF	47,01	354,14
PE10W125/30-10	KOLJENO PE100, D125/30°, SDR17	KOM	HXF	61,89	466,29
PE10W140/30-10	KOLJENO PE100, D140/30°, SDR17	KOM	HXF	75,23	566,75
PE10W160/30-10	KOLJENO PE100, D160/30°, SDR17	KOM	HXF	100,30	755,65

PE-KOLJENO 30°, SDR17



ŠIFRA	OPIS	JM	RAB	€/JM	KN/JM
PE10W180/30-10	KOLJENO PE100, D180/30°, SDR17	KOM	HXF	126,21	950,87
PE10W200/30-10	KOLJENO PE100, D200/30°, SDR17	KOM	HXF	172,09	1.296,61
PE10W225/30-10	KOLJENO PE100, D225/30°, SDR17	KOM	HXF	205,73	1.550,00
PE10W250/30-10	KOLJENO PE100, D250/30°, SDR17	KOM	HXF	401,17	3.022,61
PE10W280/30-10	KOLJENO PE100, D280/30°, SDR17	KOM	HXF	570,73	4.300,14
PE10W315/30-10	KOLJENO PE100, D315/30°, SDR17	KOM	HXF	664,59	5.007,33

PE-KOLJENO 30°, SDR11



ŠIFRA	OPIS	JM	RAB	€/JM	KN/JM
PE10W32/30-16	KOLJENO PE100, D90/30°, SDR11	KOM	HXF	13,04	98,23
PE10W40/30-16	KOLJENO PE100, D40/30°, SDR11	KOM	HXF	16,14	121,56
PE10W50/30-16	KOLJENO PE100, D50/30°, SDR11	KOM	HXF	18,33	138,10
PE10W63/30-16	KOLJENO PE100, D63/30°, SDR11	KOM	HXF	32,71	246,41
PE10W75/30-16	KOLJENO PE100, D75/30°, SDR11	KOM	HXF	41,82	315,05
PE10W90/30-16	KOLJENO PE100, D90/30°, SDR11	KOM	HXF	46,89	353,27
PE10W110/30-16	KOLJENO PE100, D110/30°, SDR11	KOM	HXF	58,64	441,78
PE10W125/30-16	KOLJENO PE100, D125/30°, SDR11	KOM	HXF	73,22	551,66
PE10W140/30-16	KOLJENO PE100, D140/30°, SDR11	KOM	HXF	89,94	677,63
PE10W160/30-16	KOLJENO PE100, D160/30°, SDR11	KOM	HXF	124,25	936,11
PE10W180/30-16	KOLJENO PE100, D180/30°, SDR11	KOM	HXF	135,66	1.022,10
PE10W200/30-16	KOLJENO PE100, D200/30°, SDR11	KOM	HXF	185,38	1.396,74
PE10W225/30-16	KOLJENO PE100, D225/30°, SDR11	KOM	HXF	214,85	1.618,76
PE10W250/30-16	KOLJENO PE100, D250/30°, SDR11	KOM	HXF	445,07	3.353,32
PE10W280/30-16	KOLJENO PE100, D280/30°, SDR11	KOM	HXF	632,81	4.767,88
PE10W315/30-16	KOLJENO PE100, D315/30°, SDR11	KOM	HXF	738,78	5.566,33



PE 100 SPOJNI ELEMENTI ZA PE CIJEVNE SUSTAVE

PE-KOLJENO 15°, SDR17



ŠIFRA	OPIS	JM	RAB	€/JM	KN/JM
PE10W90/15-10	KOLJENO PE100, D90/15°, SDR17	KOM	HXF	38,30	288,56
PE10W110/15-10	KOLJENO PE100, D110/15°, SDR17	KOM	HXF	62,66	472,11
PE10W125/15-10	KOLJENO PE100, D125/15°, SDR17	KOM	HXF	91,14	686,66
PE10W140/15-10	KOLJENO PE100, D140/15°, SDR17	KOM	HXF	100,68	758,57
PE10W160/15-10	KOLJENO PE100, D160/15°, SDR17	KOM	HXF	129,53	975,91
PE10W180/15-10	KOLJENO PE100, D180/15°, SDR17	KOM	HXF	150,01	1.130,20
PE10W200/15-10	KOLJENO PE100, D200/15°, SDR17	KOM	HXF	205,90	1.551,28
PE10W225/15-10	KOLJENO PE100, D225/15°, SDR17	KOM	HXF	246,00	1.853,42
PE10W250/15-10	KOLJENO PE100, D250/15°, SDR17	KOM	HXF	401,17	3.022,61
PE10W280/15-10	KOLJENO PE100, D280/15°, SDR17	KOM	HXF	570,73	4.300,14
PE10W315/15-10	KOLJENO PE100, D315/15°, SDR17	KOM	HXF	664,59	5.007,33

PE-KOLJENO 15°, SDR11



ŠIFRA	OPIS	JM	RAB	€/JM	KN/JM
PE10W32/15-16	KOLJENO PE100, D90/15°, SDR11	KOM	HXF	13,04	98,23
PE10W40/15-16	KOLJENO PE100, D40/15°, SDR11	KOM	HXF	16,14	121,56
PE10W50/15-16	KOLJENO PE100, D50/15°, SDR11	KOM	HXF	18,33	138,10
PE10W63/15-16	KOLJENO PE100, D63/15°, SDR11	KOM	HXF	32,71	246,41
PE10W75/15-16	KOLJENO PE100, D75/15°, SDR11	KOM	HXF	37,40	281,77
PE10W90/15-16	KOLJENO PE100, D90/15°, SDR11	KOM	HXF	42,76	322,17
PE10W110/15-16	KOLJENO PE100, D110/15°, SDR11	KOM	HXF	69,58	524,18
PE10W125/15-16	KOLJENO PE100, D125/15°, SDR11	KOM	HXF	101,06	761,37
PE10W140/15-16	KOLJENO PE100, D140/15°, SDR11	KOM	HXF	110,53	832,77
PE10W160/15-16	KOLJENO PE100, D160/15°, SDR11	KOM	HXF	147,60	1.112,09
PE10W180/15-16	KOLJENO PE100, D180/15°, SDR11	KOM	HXF	168,78	1.271,60
PE10W200/15-16	KOLJENO PE100, D200/15°, SDR11	KOM	HXF	230,12	1.733,78
PE10W225/15-16	KOLJENO PE100, D225/15°, SDR11	KOM	HXF	273,27	2.058,90
PE10W250/15-16	KOLJENO PE100, D250/15°, SDR11	KOM	HXF	445,07	3.353,32
PE10W280/15-16	KOLJENO PE100, D280/15°, SDR11	KOM	HXF	632,81	4.767,88
PE10W315/15-16	KOLJENO PE100, D315/15°, SDR11	KOM	HXF	738,78	5.566,33

PE-VUČENI LUK 90°, SDR17

ŠIFRA	OPIS	JM	RAB	€/JM	KN/JM
PE10B50/90-10	LUK PE100, D50/90°, SDR17	KOM	HXF	10,39	78,23
PE10B63/90-10	LUK PE100, D63/90°, SDR17	KOM	HXF	16,10	121,25
PE10B75/90-10	LUK PE100, D75/90°, SDR17	KOM	HXF	20,35	153,29
PE10B90/90-10	LUK PE100, D90/90°, SDR17	KOM	HXF	32,30	243,34

PE-VUČENI LUK 90°, SDR11



ŠIFRA	OPIS	JM	RAB	€/JM	KN/JM
PE10B110/90-10	LUK PE100, D110/90°, SDR17	KOM	HXF	50,99	384,14
PE10B125/90-10	LUK PE100, D125/90°, SDR17	KOM	HXF	65,90	496,49
PE10B140/90-10	LUK PE100, D140/90°, SDR17	KOM	HXF	76,02	572,76
PE10B160/90-10	LUK PE100, D160/90°, SDR17	KOM	HXF	85,85	646,78
PE10B180/90-10	LUK PE100, D180/90°, SDR17	KOM	HXF	148,10	1.115,82
PE10B200/90-10	LUK PE100, D200/90°, SDR17	KOM	HXF	164,82	1.241,82
PE10B225/90-10	LUK PE100, D225/90°, SDR17	KOM	HXF	194,45	1.465,08
PE10B250/90-10	LUK PE100, D250/90°, SDR17	KOM	HXF	245,37	1.848,71
PE10B280/90-10	LUK PE100, D280/90°, SDR17	KOM	HXF	276,64	2.084,33
PE10B315/90-10	LUK PE100, D315/90°, SDR17	KOM	HXF	366,68	2.762,72
PE10B355/90-10	LUK PE100, D355/90°, SDR17	KOM	HXF	826,71	6.228,78
PE10B400/90-10	LUK PE100, D400/90°, SDR17	KOM	HXF	1.162,12	8.755,95
PE10B450/90-10	LUK PE100, D450/90°, SDR17	KOM	HXF	1.644,83	12.392,94
PE10B500/90-10	LUK PE100, D500/90°, SDR17	KOM	HXF	2.360,66	17.786,35



PE 100 SPOJNI ELEMENTI ZA PE CIJEVNE SUSTAVE

PE-VUČENI LUK 90°, SDR11

ŠIFRA	OPIS	JM	RAB	€/JM	KN/JM
PE10B32/90-16	LUK PE100, D32/90°, SDR11	KOM	HXF	8,49	63,91
PE10B40/90-16	LUK PE100, D40/90°, SDR11	KOM	HXF	10,59	79,76
PE10B50/90-16	LUK PE100, D50/90°, SDR11	KOM	HXF	15,38	115,82
PE10B63/90-16	LUK PE100, D63/90°, SDR11	KOM	HXF	25,54	192,43
PE10B75/90-16	LUK PE100, D75/90°, SDR11	KOM	HXF	31,35	236,15
PE10B90/90-16	LUK PE100, D90/90°, SDR11	KOM	HXF	33,22	250,25
PE10B110/90-16	LUK PE100, D110/90°, SDR11	KOM	HXF	52,47	395,31
PE10B125/90-16	LUK PE100, D125/90°, SDR11	KOM	HXF	77,80	586,17
PE10B140/90-16	LUK PE100, D140/90°, SDR11	KOM	HXF	113,48	854,95
PE10B160/90-16	LUK PE100, D160/90°, SDR11	KOM	HXF	118,74	894,64
PE10B180/90-16	LUK PE100, D180/90°, SDR11	KOM	HXF	153,08	1.153,36
PE10B200/90-16	LUK PE100, D200/90°, SDR11	KOM	HXF	166,09	1.251,40
PE10B225/90-16	LUK PE100, D225/90°, SDR11	KOM	HXF	220,16	1.658,73
PE10B250/90-16	LUK PE100, D250/90°, SDR11	KOM	HXF	332,18	2.502,80
PE10B280/90-16	LUK PE100, D280/90°, SDR11	KOM	HXF	430,90	3.246,57
PE10B315/90-16	LUK PE100, D315/90°, SDR11	KOM	HXF	575,24	4.334,11
PE10B355/90-16	LUK PE100, D355/90°, SDR11	KOM	HXF	1.243,59	9.369,81
PE10B400/90-16	LUK PE100, D400/90°, SDR11	KOM	HXF	1.426,53	10.748,16
PE10B450/90-16	LUK PE100, D500/90°, SDR11	KOM	HXF	2.014,91	15.181,33
PE10B500/90-16	LUK PE100, D500/90°, SDR11	KOM	HXF	3.030,52	22.833,38

PE-VUČENI LUK 60°, SDR17

ŠIFRA	OPIS	JM	RAB	€/JM	KN/JM
PE10B50/60-10	LUK PE100, D50/60°, SDR17	KOM	HXF	38,52	290,18
PE10B63/60-10	LUK PE100, D63/60°, SDR17	KOM	HXF	57,90	436,20
PE10B75/60-10	LUK PE100, D75/60°, SDR17	KOM	HXF	61,90	466,38
PE10B90/60-10	LUK PE100, D90/60°, SDR17	KOM	HXF	77,85	586,52
PE10B110/60-10	LUK PE100, D110/60°, SDR17	KOM	HXF	98,17	739,60
PE10B125/60-10	LUK PE100, D125/60°, SDR17	KOM	HXF	112,10	844,60
PE10B140/60-10	LUK PE100, D140/60°, SDR17	KOM	HXF	128,07	964,94
PE10B160/60-10	LUK PE100, D160/60°, SDR17	KOM	HXF	143,07	1.077,95
PE10B180/60-10	LUK PE100, D180/60°, SDR17	KOM	HXF	227,16	1.711,49
PE10B200/60-10	LUK PE100, D200/60°, SDR17	KOM	HXF	273,55	2.060,99
PE10B225/60-10	LUK PE100, D225/60°, SDR17	KOM	HXF	322,59	2.430,53
PE10B250/60-10	LUK PE100, D250/60°, SDR17	KOM	HXF	403,51	3.040,21
PE10B280/60-10	LUK PE100, D280/60°, SDR17	KOM	HXF	450,36	3.393,20
PE10B315/60-10	LUK PE100, D315/60°, SDR17	KOM	HXF	585,75	4.413,33
PE10B355/60-10	LUK PE100, D355/60°, SDR17	KOM	HXF	860,84	6.485,99
PE10B400/60-10	LUK PE100, D400/60°, SDR17	KOM	HXF	1.228,99	9.259,75
PE10B450/60-10	LUK PE100, D450/60°, SDR17	KOM	HXF	1.495,20	11.265,53
PE10B500/60-10	LUK PE100, D500/60°, SDR17	KOM	HXF	2.146,06	16.169,42

PE-VUČENI LUK 60°, SDR11

ŠIFRA	OPIS	JM	RAB	€/JM	KN/JM
PE10B32/60-16	LUK PE100, D32/60°, SDR11	KOM	HXF	36,59	275,68
PE10B40/60-16	LUK PE100, D40/60°, SDR11	KOM	HXF	39,88	300,41
PE10B50/60-16	LUK PE100, D50/60°, SDR11	KOM	HXF	55,45	417,77

PE-VUČENI LUK 60°, SDR11

ŠIFRA	OPIS	JM	RAB	€/JM	KN/JM
PE10B63/60-16	LUK PE100, D63/60°, SDR11	KOM	HXF	77,55	584,26
PE10B75/60-16	LUK PE100, D75/60°, SDR11	KOM	HXF	85,45	643,82
PE10B90/60-16	LUK PE100, D90/60°, SDR11	KOM	HXF	95,30	718,00
PE10B110/60-16	LUK PE100, D110/60°, SDR11	KOM	HXF	124,21	935,85
PE10B125/60-16	LUK PE100, D125/60°, SDR11	KOM	HXF	140,35	1.057,40
PE10B140/60-16	LUK PE100, D140/60°, SDR11	KOM	HXF	159,05	1.198,29
PE10B160/60-16	LUK PE100, D160/60°, SDR11	KOM	HXF	188,28	1.418,58
PE10B180/60-16	LUK PE100, D180/60°, SDR11	KOM	HXF	310,55	2.339,80
PE10B200/60-16	LUK PE100, D200/60°, SDR11	KOM	HXF	376,19	2.834,37
PE10B225/60-16	LUK PE100, D225/60°, SDR11	KOM	HXF	446,24	3.362,19
PE10B250/60-16	LUK PE100, D250/60°, SDR11	KOM	HXF	537,59	4.050,42
PE10B280/60-16	LUK PE100, D280/60°, SDR11	KOM	HXF	646,10	4.868,02
PE10B315/60-16	LUK PE100, D315/60°, SDR11	KOM	HXF	794,88	5.988,98
PE10B355/60-16	LUK PE100, D355/60°, SDR11	KOM	HXF	1.350,21	10.173,14
PE10B400/60-16	LUK PE100, D400/60°, SDR11	KOM	HXF	1.489,88	11.225,49
PE10B450/60-16	LUK PE100, D500/60°, SDR11	KOM	HXF	1.831,84	13.801,95
PE10B500/60-16	LUK PE100, D500/60°, SDR11	KOM	HXF	2.755,17	20.758,82



PE 100 SPOJNI ELEMENTI ZA PE CIJEVNE SUSTAVE

PE-VUČENI LUK 45°, SDR17



ŠIFRA	OPIS	JM	RAB	€/JM	KN/JM
PE10B50/45-10	LUK PE100, D50/45°, SDR17	KOM	HXF	39,71	299,12
PE10B63/45-10	LUK PE100, D63/45°, SDR17	KOM	HXF	57,90	436,20
PE10B75/45-10	LUK PE100, D75/45°, SDR17	KOM	HXF	61,90	466,38
PE10B90/45-10	LUK PE100, D90/45°, SDR17	KOM	HXF	65,19	491,14
PE10B110/45-10	LUK PE100, D110/45°, SDR17	KOM	HXF	80,54	606,81
PE10B125/45-10	LUK PE100, D125/45°, SDR17	KOM	HXF	100,50	757,16
PE10B140/45-10	LUK PE100, D140/45°, SDR17	KOM	HXF	110,25	830,62
PE10B160/45-10	LUK PE100, D160/45°, SDR17	KOM	HXF	144,53	1.088,92
PE10B180/45-10	LUK PE100, D180/45°, SDR17	KOM	HXF	189,36	1.426,71
PE10B200/45-10	LUK PE100, D200/45°, SDR17	KOM	HXF	252,73	1.904,13
PE10B225/45-10	LUK PE100, D225/45°, SDR17	KOM	HXF	315,21	2.374,91
PE10B250/45-10	LUK PE100, D250/45°, SDR17	KOM	HXF	348,76	2.627,66
PE10B280/45-10	LUK PE100, D280/45°, SDR17	KOM	HXF	428,41	3.227,82
PE10B315/45-10	LUK PE100, D315/45°, SDR17	KOM	HXF	581,41	4.380,59
PE10B355/45-10	LUK PE100, D355/45°, SDR17	KOM	HXF	852,78	6.425,21
PE10B400/45-10	LUK PE100, D400/45°, SDR17	KOM	HXF	1.138,92	8.581,19
PE10B450/45-10	LUK PE100, D450/45°, SDR17	KOM	HXF	1.423,80	10.727,61
PE10B500/45-10	LUK PE100, D500/45°, SDR17	KOM	HXF	1.950,87	14.698,78

PE-VUČENI LUK 45°, SDR11

ŠIFRA	OPIS	JM	RAB	€/JM	KN/JM
PE10B32/45-16	LUK PE100, D32/45°, SDR11	KOM	HXF	35,70	268,95
PE10B40/45-16	LUK PE100, D40/45°, SDR11	KOM	HXF	38,89	292,98
PE10B50/45-16	LUK PE100, D50/45°, SDR11	KOM	HXF	48,09	362,26
PE10B63/45-16	LUK PE100, D63/45°, SDR11	KOM	HXF	61,53	463,59
PE10B75/45-16	LUK PE100, D75/45°, SDR11	KOM	HXF	65,54	493,75
PE10B90/45-16	LUK PE100, D90/45°, SDR11	KOM	HXF	68,82	518,52
PE10B110/45-16	LUK PE100, D110/45°, SDR11	KOM	HXF	102,07	769,03
PE10B125/45-16	LUK PE100, D125/45°, SDR11	KOM	HXF	113,02	851,54
PE10B140/45-16	LUK PE100, D140/45°, SDR11	KOM	HXF	127,86	963,29
PE10B160/45-16	LUK PE100, D160/45°, SDR11	KOM	HXF	148,65	1.119,99
PE10B180/45-16	LUK PE100, D180/45°, SDR11	KOM	HXF	248,55	1.872,64
PE10B200/45-16	LUK PE100, D200/45°, SDR11	KOM	HXF	279,98	2.109,47
PE10B225/45-16	LUK PE100, D225/45°, SDR11	KOM	HXF	316,63	2.385,62
PE10B250/45-16	LUK PE100, D250/45°, SDR11	KOM	HXF	422,37	3.182,28
PE10B280/45-16	LUK PE100, D280/45°, SDR11	KOM	HXF	502,19	3.783,68
PE10B315/45-16	LUK PE100, D315/45°, SDR11	KOM	HXF	608,83	4.587,16
PE10B355/45-16	LUK PE100, D355/45°, SDR11	KOM	HXF	1.109,33	8.358,24
PE10B400/45-16	LUK PE100, D400/45°, SDR11	KOM	HXF	1.350,29	10.173,70
PE10B450/45-16	LUK PE100, D500/45°, SDR11	KOM	HXF	1.684,00	12.688,04
PE10B500/45-16	LUK PE100, D500/45°, SDR11	KOM	HXF	2.504,54	18.870,40

PE-VUČENI LUK 30°, SDR17



ŠIFRA	OPIS	JM	RAB	€/JM	KN/JM
PE10B50/30-10	LUK PE100, D50/30°, SDR17	KOM	HXF	39,71	299,12
PE10B63/30-10	LUK PE100, D63/30°, SDR17	KOM	HXF	57,90	436,20
PE10B75/30-10	LUK PE100, D75/30°, SDR17	KOM	HXF	61,90	466,38
PE10B90/30-10	LUK PE100, D90/30°, SDR17	KOM	HXF	64,82	488,36
PE10B110/30-10	LUK PE100, D110/30°, SDR17	KOM	HXF	80,54	606,81
PE10B125/30-10	LUK PE100, D125/30°, SDR17	KOM	HXF	91,47	689,13
PE10B140/30-10	LUK PE100, D140/30°, SDR17	KOM	HXF	104,20	785,05
PE10B160/30-10	LUK PE100, D160/30°, SDR17	KOM	HXF	111,96	843,53
PE10B180/30-10	LUK PE100, D180/30°, SDR17	KOM	HXF	184,24	1.388,13
PE10B200/30-10	LUK PE100, D200/30°, SDR17	KOM	HXF	222,83	1.678,87
PE10B225/30-10	LUK PE100, D225/30°, SDR17	KOM	HXF	269,89	2.033,48
PE10B250/30-10	LUK PE100, D250/30°, SDR17	KOM	HXF	318,54	2.400,03
PE10B280/30-10	LUK PE100, D280/30°, SDR17	KOM	HXF	352,09	2.652,76
PE10B315/30-10	LUK PE100, D315/30°, SDR17	KOM	HXF	454,50	3.424,40
PE10B355/30-10	LUK PE100, D355/30°, SDR17	KOM	HXF	723,25	5.449,31
PE10B400/30-10	LUK PE100, D400/30°, SDR17	KOM	HXF	1.098,33	8.275,35
PE10B450/30-10	LUK PE100, D450/30°, SDR17	KOM	HXF	1.339,91	10.095,52
PE10B500/30-10	LUK PE100, D500/30°, SDR17	KOM	HXF	1.950,87	14.698,78



PE 100 SPOJNI ELEMENTI ZA PE CIJEVNE SUSTAVE

PE-VUČENI LUK 30°, SDR11



ŠIFRA	OPIS	JM	RAB	€/JM	KN/JM
PE10B32/30-16	LUK PE100, D32/30°, SDR11	KOM	HXF	36,59	275,68
PE10B40/30-16	LUK PE100, D40/30°, SDR11	KOM	HXF	39,88	300,41
PE10B50/30-16	LUK PE100, D50/30°, SDR11	KOM	HXF	55,04	414,65
PE10B63/30-16	LUK PE100, D63/30°, SDR11	KOM	HXF	76,88	579,21
PE10B75/30-16	LUK PE100, D75/30°, SDR11	KOM	HXF	84,37	635,63
PE10B90/30-16	LUK PE100, D90/30°, SDR11	KOM	HXF	93,38	703,54
PE10B110/30-16	LUK PE100, D110/30°, SDR11	KOM	HXF	120,84	910,43
PE10B125/30-16	LUK PE100, D125/30°, SDR11	KOM	HXF	134,59	1.014,05
PE10B140/30-16	LUK PE100, D140/30°, SDR11	KOM	HXF	151,51	1.141,52
PE10B160/30-16	LUK PE100, D160/30°, SDR11	KOM	HXF	177,88	1.340,22
PE10B180/30-16	LUK PE100, D180/30°, SDR11	KOM	HXF	297,61	2.242,28
PE10B200/30-16	LUK PE100, D200/30°, SDR11	KOM	HXF	360,52	2.716,30
PE10B225/30-16	LUK PE100, D225/30°, SDR11	KOM	HXF	430,27	3.241,86
PE10B250/30-16	LUK PE100, D250/30°, SDR11	KOM	HXF	501,53	3.778,75
PE10B280/30-16	LUK PE100, D280/30°, SDR11	KOM	HXF	596,29	4.492,74
PE10B315/30-16	LUK PE100, D315/30°, SDR11	KOM	HXF	723,23	5.449,13
PE10B355/30-16	LUK PE100, D355/30°, SDR11	KOM	HXF	1.323,08	9.968,69
PE10B400/30-16	LUK PE100, D400/30°, SDR11	KOM	HXF	1.455,19	10.964,10
PE10B450/30-16	LUK PE100, D500/30°, SDR11	KOM	HXF	1.684,00	12.688,04
PE10B500/30-16	LUK PE100, D500/30°, SDR11	KOM	HXF	2.504,54	18.870,40

PE-VUČENI LUK 22°, SDR17



ŠIFRA	OPIS	JM	RAB	€/JM	KN/JM
PE10B50/22-10	LUK PE100, D50/22°, SDR17	KOM	HXF	39,71	299,12
PE10B63/22-10	LUK PE100, D63/22°, SDR17	KOM	HXF	57,90	436,20
PE10B75/22-10	LUK PE100, D75/22°, SDR17	KOM	HXF	61,90	466,38
PE10B90/22-10	LUK PE100, D90/22°, SDR17	KOM	HXF	76,72	577,99
PE10B110/22-10	LUK PE100, D110/22°, SDR17	KOM	HXF	95,85	722,18
PE10B125/22-10	LUK PE100, D125/22°, SDR17	KOM	HXF	100,62	758,05
PE10B140/22-10	LUK PE100, D140/22°, SDR17	KOM	HXF	104,20	785,05
PE10B160/22-10	LUK PE100, D160/22°, SDR17	KOM	HXF	111,96	843,53
PE10B180/22-10	LUK PE100, D180/22°, SDR17	KOM	HXF	184,24	1.388,13
PE10B200/22-10	LUK PE100, D200/22°, SDR17	KOM	HXF	222,83	1.678,87
PE10B225/22-10	LUK PE100, D225/22°, SDR17	KOM	HXF	269,89	2.033,48
PE10B250/22-10	LUK PE100, D250/22°, SDR17	KOM	HXF	318,54	2.400,03
PE10B280/22-10	LUK PE100, D280/22°, SDR17	KOM	HXF	352,09	2.652,76
PE10B315/22-10	LUK PE100, D315/22°, SDR17	KOM	HXF	454,50	3.424,40
PE10B355/22-10	LUK PE100, D355/22°, SDR17	KOM	HXF	723,25	5.449,31
PE10B400/22-10	LUK PE100, D400/22°, SDR17	KOM	HXF	1.098,33	8.275,35
PE10B450/22-10	LUK PE100, D450/22°, SDR17	KOM	HXF	1.339,91	10.095,52
PE10B500/22-10	LUK PE100, D500/22°, SDR17	KOM	HXF	1.950,87	14.698,78

PE-VUČENI LUK 22°, SDR11



ŠIFRA	OPIS	JM	RAB	€/JM	KN/JM
PE10B32/22-16	LUK PE100, D32/22°, SDR11	KOM	HXF	36,59	275,68
PE10B40/22-16	LUK PE100, D40/22°, SDR11	KOM	HXF	39,88	300,41
PE10B50/22-16	LUK PE100, D50/22°, SDR11	KOM	HXF	55,04	414,65
PE10B63/22-16	LUK PE100, D63/22°, SDR11	KOM	HXF	76,88	579,21
PE10B75/22-16	LUK PE100, D75/22°, SDR11	KOM	HXF	84,37	635,63
PE10B90/22-16	LUK PE100, D90/22°, SDR11	KOM	HXF	93,38	703,54
PE10B110/22-16	LUK PE100, D110/22°, SDR11	KOM	HXF	102,07	769,03
PE10B125/22-16	LUK PE100, D125/22°, SDR11	KOM	HXF	113,02	851,54
PE10B140/22-16	LUK PE100, D140/22°, SDR11	KOM	HXF	127,86	963,29
PE10B160/22-16	LUK PE100, D160/22°, SDR11	KOM	HXF	145,85	1.098,88
PE10B180/22-16	LUK PE100, D180/22°, SDR11	KOM	HXF	297,61	2.242,28
PE10B200/22-16	LUK PE100, D200/22°, SDR11	KOM	HXF	360,52	2.716,30
PE10B225/22-16	LUK PE100, D225/22°, SDR11	KOM	HXF	430,27	3.241,86
PE10B250/22-16	LUK PE100, D250/22°, SDR11	KOM	HXF	501,53	3.778,75
PE10B280/22-16	LUK PE100, D280/22°, SDR11	KOM	HXF	596,29	4.492,74
PE10B315/22-16	LUK PE100, D315/22°, SDR11	KOM	HXF	723,23	5.449,13
PE10B355/22-16	LUK PE100, D355/22°, SDR11	KOM	HXF	1.323,08	9.968,69
PE10B400/22-16	LUK PE100, D400/22°, SDR11	KOM	HXF	1.455,19	10.964,10
PE10B450/22-16	LUK PE100, D500/22°, SDR11	KOM	HXF	1.788,29	13.473,85
PE10B500/22-16	LUK PE100, D500/22°, SDR11	KOM	HXF	2.504,54	18.870,40



PE 100 SPOJNI ELEMENTI ZA PE CIJEVNE SUSTAVE

PE-VUČENI LUK 11°, SDR17



ŠIFRA	OPIS	JM	RAB	€/JM	KN/JM
PE10B50/11-10	LUK PE100, D50/11°, SDR17	KOM	HXF	39,71	299,12
PE10B63/11-10	LUK PE100, D63/11°, SDR17	KOM	HXF	57,90	436,20
PE10B75/11-10	LUK PE100, D75/11°, SDR17	KOM	HXF	61,90	466,38
PE10B90/11-10	LUK PE100, D90/11°, SDR17	KOM	HXF	81,02	610,44
PE10B110/11-10	LUK PE100, D110/11°, SDR17	KOM	HXF	84,57	637,15
PE10B125/11-10	LUK PE100, D125/11°, SDR17	KOM	HXF	91,47	689,13
PE10B140/11-10	LUK PE100, D140/11°, SDR17	KOM	HXF	104,20	785,05
PE10B160/11-10	LUK PE100, D160/11°, SDR17	KOM	HXF	111,96	843,53
PE10B180/11-10	LUK PE100, D180/11°, SDR17	KOM	HXF	184,24	1.388,13
PE10B200/11-10	LUK PE100, D200/11°, SDR17	KOM	HXF	222,83	1.678,87
PE10B225/11-10	LUK PE100, D225/11°, SDR17	KOM	HXF	269,89	2.033,48
PE10B250/11-10	LUK PE100, D250/11°, SDR17	KOM	HXF	318,54	2.400,03
PE10B280/11-10	LUK PE100, D280/11°, SDR17	KOM	HXF	352,09	2.652,76
PE10B315/11-10	LUK PE100, D315/11°, SDR17	KOM	HXF	454,50	3.424,40
PE10B355/11-10	LUK PE100, D355/11°, SDR17	KOM	HXF	723,25	5.449,31
PE10B400/11-10	LUK PE100, D400/11°, SDR17	KOM	HXF	1.098,33	8.275,35
PE10B450/11-10	LUK PE100, D450/11°, SDR17	KOM	HXF	1.339,91	10.095,52
PE10B500/11-10	LUK PE100, D500/11°, SDR17	KOM	HXF	1.950,87	14.698,78

PE-VUČENI LUK 11°, SDR11



ŠIFRA	OPIS	JM	RAB	€/JM	KN/JM
PE10B32/11-16	LUK PE100, D32/11°, SDR11	KOM	HXF	36,59	275,68
PE10B40/11-16	LUK PE100, D40/11°, SDR11	KOM	HXF	39,88	300,41
PE10B50/11-16	LUK PE100, D50/11°, SDR11	KOM	HXF	55,04	414,65
PE10B63/11-16	LUK PE100, D63/11°, SDR11	KOM	HXF	76,88	579,21
PE10B75/11-16	LUK PE100, D75/11°, SDR11	KOM	HXF	84,37	635,63
PE10B90/11-16	LUK PE100, D90/11°, SDR11	KOM	HXF	86,03	648,15
PE10B110/11-16	LUK PE100, D110/11°, SDR11	KOM	HXF	102,07	769,03
PE10B125/11-16	LUK PE100, D125/11°, SDR11	KOM	HXF	113,02	851,54
PE10B140/11-16	LUK PE100, D140/11°, SDR11	KOM	HXF	127,86	963,29
PE10B160/11-16	LUK PE100, D160/11°, SDR11	KOM	HXF	148,65	1.119,99
PE10B180/11-16	LUK PE100, D180/11°, SDR11	KOM	HXF	248,55	1.872,64
PE10B200/11-16	LUK PE100, D200/11°, SDR11	KOM	HXF	279,98	2.109,47
PE10B225/11-16	LUK PE100, D225/11°, SDR11	KOM	HXF	316,63	2.385,62
PE10B250/11-16	LUK PE100, D250/11°, SDR11	KOM	HXF	422,37	3.182,28
PE10B280/11-16	LUK PE100, D280/11°, SDR11	KOM	HXF	502,19	3.783,68
PE10B315/11-16	LUK PE100, D315/11°, SDR11	KOM	HXF	608,83	4.587,16
PE10B355/11-16	LUK PE100, D355/11°, SDR11	KOM	HXF	1.109,33	8.358,24
PE10B400/11-16	LUK PE100, D400/11°, SDR11	KOM	HXF	1.350,29	10.173,70

PE-VUČENI LUK 11°, SDR11

ŠIFRA	OPIS	JM	RAB	€/JM	KN/JM
PE10B450/11-16	LUK PE100, D500/11°, SDR11	KOM	HXF	1.684,00	12.688,04
PE10B500/11-16	LUK PE100, D500/11°, SDR11	KOM	HXF	2.427,50	18.289,94

PE-RAČVA 45°, SDR17



ŠIFRA	OPIS	JM	RAB	€/JM	KN/JM
PE10EA63/45-10	RAČVA PE100, D63/45°, SDR17	KOM	HXF	18,93	142,60
PE10EA75/45-10	RAČVA PE100, D75/45°, SDR17	KOM	HXF	28,75	216,57
PE10EA90/45-10	RAČVA PE100, D90/45°, SDR17	KOM	HXF	44,53	335,48
PE10EA110/45-10	RAČVA PE100, D110/45°, SDR17	KOM	HXF	63,58	478,97
PE10EA125/45-10	RAČVA PE100, D125/45°, SDR17	KOM	HXF	89,65	675,42
PE10EA140/45-10	RAČVA PE100, D140/45°, SDR17	KOM	HXF	139,72	1.052,69
PE10EA160/45-10	RAČVA PE100, D160/45°, SDR17	KOM	HXF	157,13	1.183,89
PE10EA180/45-10	RAČVA PE100, D180/45°, SDR17	KOM	HXF	219,99	1.657,48
PE10EA200/45-10	RAČVA PE100, D200/45°, SDR17	KOM	HXF	319,90	2.410,23
PE10EA225/45-10	RAČVA PE100, D225/45°, SDR17	KOM	HXF	390,23	2.940,15



PE 100 SPOJNI ELEMENTI ZA PE CIJEVNE SUSTAVE

PE-RAČVA 45°, SDR11



ŠIFRA	OPIS	JM	RAB	€/JM	KN/JM
PE10EA63/45-16	RAČVA PE100, D63/45°, SDR11	KOM	HXF	20,98	158,01
PE10EA75/45-16	RAČVA PE100, D75/45°, SDR11	KOM	HXF	31,95	240,71
PE10EA90/45-16	RAČVA PE100, D90/45°, SDR11	KOM	HXF	49,45	372,58
PE10EA110/45-16	RAČVA PE100, D110/45°, SDR11	KOM	HXF	70,63	532,16
PE10EA125/45-16	RAČVA PE100, D125/45°, SDR11	KOM	HXF	99,62	750,52
PE10EA140/45-16	RAČVA PE100, D140/45°, SDR11	KOM	HXF	155,84	1.174,12
PE10EA160/45-16	RAČVA PE100, D160/45°, SDR11	KOM	HXF	174,58	1.315,30
PE10EA180/45-16	RAČVA PE100, D180/45°, SDR11	KOM	HXF	251,73	1.896,63
PE10EA200/45-16	RAČVA PE100, D200/45°, SDR11	KOM	HXF	366,11	2.758,44
PE10EA225/45-16	RAČVA PE100, D225/45°, SDR11	KOM	HXF	433,60	3.266,91

PE-T-KOMAD EGAL, SDR17



ŠIFRA	OPIS	JM	RAB	€/JM	KN/JM
PE10T63-10	T-EGAL PE100, D63, SDR17	KOM	HXF	7,64	57,56
PE10T75-10	T-EGAL PE100, D75, SDR17	KOM	HXF	11,46	86,28
PE10T90-10	T-EGAL PE100, D90, SDR17	KOM	HXF	16,72	125,95
PE10T110-10	T-EGAL PE100, D110, SDR17	KOM	HXF	24,65	185,70
PE10T125-10	T-EGAL PE100, D125, SDR17	KOM	HXF	37,44	282,09
PE10T140-10	T-EGAL PE100, D140, SDR17	KOM	HXF	54,64	411,67
PE10T160-10	T-EGAL PE100, D160, SDR17	KOM	HXF	69,23	521,56
PE10T180-10	T-EGAL PE100, D180, SDR17	KOM	HXF	93,05	701,04
PE10T200-10	T-EGAL PE100, D200, SDR17	KOM	HXF	137,40	1.035,17
PE10T225-10	T-EGAL PE100, D225, SDR17	KOM	HXF	165,45	1.246,58
PE10T250-10	T-EGAL PE100, D250, SDR17	KOM	HXF	273,27	2.058,90
PE10T280-10	T-EGAL PE100, D280, SDR17	KOM	HXF	381,93	2.877,64
PE10T315-10	T-EGAL PE100, D315, SDR17	KOM	HXF	539,71	4.066,44
PE10T355-10	T-EGAL PE100, D355, SDR17	KOM	HXF	998,70	7.524,63
PE10T400-10	T-EGAL PE100, D400, SDR17	KOM	HXF	1.374,79	10.358,32
PE10T450-10	T-EGAL PE100, D450, SDR17	KOM	HXF	2.263,19	17.051,96
PE10T500-10	T-EGAL PE100, D500, SDR17	KOM	HXF	2.453,87	18.488,67

PE-T-KOMAD EGAL, SDR11



ŠIFRA	OPIS	JM	RAB	€/JM	KN/JM
PE10T20-16	T-EGAL PE100, D20, SDR11	KOM	HXF	3,29	24,74
PE10T25-16	T-EGAL PE100, D25, SDR11	KOM	HXF	3,76	28,28
PE10T32-16	T-EGAL PE100, D32, SDR11	KOM	HXF	4,16	31,34
PE10T40-16	T-EGAL PE100, D40, SDR11	KOM	HXF	5,12	38,56
PE10T50-16	T-EGAL PE100, D50, SDR11	KOM	HXF	5,92	44,55
PE10T63-16	T-EGAL PE100, D63, SDR11	KOM	HXF	8,08	60,84
PE10T75-16	T-EGAL PE100, D75, SDR11	KOM	HXF	11,52	86,75
PE10T90-16	T-EGAL PE100, D90, SDR11	KOM	HXF	18,40	138,59
PE10T110-16	T-EGAL PE100, D110, SDR11	KOM	HXF	27,15	204,55
PE10T125-16	T-EGAL PE100, D125, SDR11	KOM	HXF	40,84	307,67
PE10T140-16	T-EGAL PE100, D140, SDR11	KOM	HXF	60,07	452,58
PE10T160-16	T-EGAL PE100, D160, SDR11	KOM	HXF	76,11	573,38
PE10T180-16	T-EGAL PE100, D180, SDR11	KOM	HXF	98,90	745,09
PE10T200-16	T-EGAL PE100, D200, SDR11	KOM	HXF	142,41	1.072,96

PE-T-KOMAD EGAL, SDR11



ŠIFRA	OPIS	JM	RAB	€/JM	KN/JM
PE10T225-16	T-EGAL PE100, D225, SDR11	KOM	HXF	168,74	1.271,34
PE10T250-16	T-EGAL PE100, D250, SDR11	KOM	HXF	300,17	2.261,61
PE10T280-16	T-EGAL PE100, D280, SDR11	KOM	HXF	527,54	3.974,68
PE10T315-16	T-EGAL PE100, D315, SDR11	KOM	HXF	585,67	4.412,71
PE10T355-16	T-EGAL PE100, D355, SDR11	KOM	HXF	1.063,14	8.010,21
PE10T400-16	T-EGAL PE100, D400, SDR11	KOM	HXF	1.410,71	10.628,92
PE10T450-16	T-EGAL PE100, D450, SDR11	KOM	HXF	2.386,64	17.982,12
PE10T500-16	T-EGAL PE100, D500, SDR11	KOM	HXF	2.941,69	22.164,12



PE 100 SPOJNI ELEMENTI ZA PE CIJEVNE SUSTAVE



PE-T-KOMAD REDUCIRANI, SDR17

ŠIFRA	OPIS	JM	RAB	€/JM	KN/JM
PE10T75/63-10	T-RED. PE100, D75/60, SDR17	KOM	HXF	13,90	104,67
PE10T90/50-10	T-RED. PE100, D90/50, SDR17	KOM	HXF	28,83	217,16
PE10T90/63-10	T-RED. PE100, D90/63, SDR17	KOM	HXF	28,83	217,16
PE10T90/75-10	T-RED. PE100, D90/75, SDR17	KOM	HXF	28,83	217,16
PE10T110/63-10	T-RED. PE100, D110/63, SDR17	KOM	HXF	36,84	277,52
PE10T110/75-10	T-RED. PE100, D110/75, SDR17	KOM	HXF	36,84	277,52
PE10T110/90-10	T-RED. PE100, D110/90, SDR17	KOM	HXF	36,84	277,52
PE10T125/63-10	T-RED. PE100, D125/63, SDR17	KOM	HXF	40,40	304,36
PE10T125/75-10	T-RED. PE100, D125/75, SDR17	KOM	HXF	40,40	304,36
PE10T125/90-10	T-RED. PE100, D125/90, SDR17	KOM	HXF	40,40	304,36
PE10T125/110-10	T-RED. PE100, D125/110, SDR17	KOM	HXF	40,40	304,36
PE10T140/63-10	T-RED. PE100, D140/63, SDR17	KOM	HXF	60,41	455,15
PE10T140/75-10	T-RED. PE100, D140/75, SDR17	KOM	HXF	60,41	455,15
PE10T140/90-10	T-RED. PE100, D140/90, SDR17	KOM	HXF	62,83	473,36
PE10T140/110-10	T-RED. PE100, D140/110, SDR17	KOM	HXF	62,83	473,36
PE10T140/125-10	T-RED. PE100, D140/125, SDR17	KOM	HXF	62,83	473,36
PE10T160/63-10	T-RED. PE100, D160/63, SDR17	KOM	HXF	76,34	575,15
PE10T160/75-10	T-RED. PE100, D160/75, SDR17	KOM	HXF	77,90	586,88
PE10T160/90-10	T-RED. PE100, D160/90, SDR17	KOM	HXF	79,48	598,79
PE10T160/110-10	T-RED. PE100, D160/110, SDR17	KOM	HXF	81,14	611,28
PE10T160/125-10	T-RED. PE100, D160/125, SDR17	KOM	HXF	81,14	611,28
PE10T180/75-10	T-RED. PE100, D180/75, SDR17	KOM	HXF	107,06	806,63
PE10T180/90-10	T-RED. PE100, D180/90, SDR17	KOM	HXF	107,06	806,63
PE10T180/110-10	T-RED. PE100, D180/110, SDR17	KOM	HXF	107,06	806,63
PE10T180/125-10	T-RED. PE100, D180/125, SDR17	KOM	HXF	107,06	806,63
PE10T180/140-10	T-RED. PE100, D180/140, SDR17	KOM	HXF	107,06	806,63
PE10T180/160-10	T-RED. PE100, D180/160, SDR17	KOM	HXF	109,39	824,17
PE10T200/63-10	T-RED. PE100, D200/63, SDR17	KOM	HXF	138,62	1.044,38
PE10T200/75-10	T-RED. PE100, D200/75, SDR17	KOM	HXF	138,62	1.044,38
PE10T200/90-10	T-RED. PE100, D200/90, SDR17	KOM	HXF	152,82	1.151,40
PE10T200/110-10	T-RED. PE100, D200/110, SDR17	KOM	HXF	173,59	1.307,85
PE10T200/125-10	T-RED. PE100, D200/125, SDR17	KOM	HXF	173,59	1.307,85
PE10T200/160-10	T-RED. PE100, D200/160, SDR17	KOM	HXF	173,59	1.307,85
PE10T225/63-10	T-RED. PE100, D225/63, SDR17	KOM	HXF	274,75	2.070,05
PE10T225/75-10	T-RED. PE100, D225/75, SDR17	KOM	HXF	274,75	2.070,05
PE10T225/90-10	T-RED. PE100, D225/90, SDR17	KOM	HXF	274,75	2.070,05
PE10T225/110-10	T-RED. PE100, D225/110, SDR17	KOM	HXF	274,75	2.070,05
PE10T225/125-10	T-RED. PE100, D225/125, SDR17	KOM	HXF	274,75	2.070,05
PE10T225/140-10	T-RED. PE100, D225/140, SDR17	KOM	HXF	274,75	2.070,05
PE10T225/160-10	T-RED. PE100, D225/160, SDR17	KOM	HXF	274,75	2.070,05
PE10T225/180-10	T-RED. PE100, D225/180, SDR17	KOM	HXF	274,75	2.070,05
PE10T250/90-10	T-RED. PE100, D250/90, SDR17	KOM	HXF	288,54	2.174,00
PE10T250/110-10	T-RED. PE100, D250/110, SDR17	KOM	HXF	288,54	2.174,00
PE10T225/125-10	T-RED. PE100, D225/125, SDR17	KOM	HXF	274,75	2.070,05
PE10T250/160-10	T-RED. PE100, D250/160, SDR17	KOM	HXF	288,54	2.174,00
PE10T250/225-10	T-RED. PE100, D250/225, SDR17	KOM	HXF	288,54	2.174,00
PE10T280/110-10	T-RED. PE100, D280/110, SDR17	KOM	HXF	310,95	2.342,84
PE10T280/160-10	T-RED. PE100, D280/160, SDR17	KOM	HXF	310,95	2.342,84
PE10T280/200-10	T-RED. PE100, D280/200, SDR17	KOM	HXF	310,95	2.342,84
PE10T280/225-10	T-RED. PE100, D280/225, SDR17	KOM	HXF	310,95	2.342,84
PE10T280/250-10	T-RED. PE100, D280/250, SDR17	KOM	HXF	310,95	2.342,84

PE-T-KOMAD REDUCIRANI, SDR17

ŠIFRA	OPIS	JM	RAB	€/JM	KN/JM
PE10T315/110-10	T-RED. PE100, D315/110, SDR17	KOM	HXF	477,72	3.599,38
PE10T315/160-10	T-RED. PE100, D315/160, SDR17	KOM	HXF	477,72	3.599,38
PE10T315/200-10	T-RED. PE100, D315/200, SDR17	KOM	HXF	477,72	3.599,38
PE10T315/225-10	T-RED. PE100, D315/225, SDR17	KOM	HXF	477,72	3.599,38
PE10T315/250-10	T-RED. PE100, D315/250, SDR17	KOM	HXF	477,72	3.599,38



PE 100 SPOJNI ELEMENTI ZA PE CIJEVNE SUSTAVE

PE-T-KOMAD REDUCIRANI, SDR11



ŠIFRA	OPIS	JM	RAB	€/JM	KN/JM
PE10T50/25-16	T-RED. PE100, D50/25, SDR11	KOM	HXF	8,51	64,07
PE10T50/32-16	T-RED. PE100, D50/32, SDR11	KOM	HXF	16,97	127,85
PE10T50/40-16	T-RED. PE100, D50/40, SDR11	KOM	HXF	8,68	65,38
PE10T63/32-16	T-RED. PE100, D63/32, SDR11	KOM	HXF	9,30	70,05
PE10T63/40-16	T-RED. PE100, D63/40, SDR11	KOM	HXF	10,59	79,72
PE10T63/50-16	T-RED. PE100, D63/50, SDR11	KOM	HXF	14,30	107,74
PE10T75/32-16	T-RED. PE100, D75/32, SDR11	KOM	HXF	22,47	169,27
PE10T75/40-16	T-RED. PE100, D75/40, SDR11	KOM	HXF	22,47	169,27
PE10T75/50-16	T-RED. PE100, D75/50, SDR11	KOM	HXF	22,47	169,27
PE10T75/63-16	T-RED. PE100, D75/63, SDR11	KOM	HXF	22,47	169,27
PE10T90/50-16	T-RED. PE100, D90/50, SDR11	KOM	HXF	30,63	230,76
PE10T90/63-16	T-RED. PE100, D90/63, SDR11	KOM	HXF	30,63	230,76
PE10T90/75-16	T-RED. PE100, D90/75, SDR11	KOM	HXF	30,63	230,76
PE10T110/50-16	T-RED. PE100, D110/50, SDR11	KOM	HXF	42,59	320,88
PE10T110/63-16	T-RED. PE100, D110/63, SDR11	KOM	HXF	42,59	320,88
PE10T110/75-16	T-RED. PE100, D110/75, SDR11	KOM	HXF	42,59	320,88
PE10T110/90-16	T-RED. PE100, D110/90, SDR11	KOM	HXF	42,59	320,88
PE10T125/63-16	T-RED. PE100, D125/63, SDR11	KOM	HXF	47,05	354,44
PE10T125/75-16	T-RED. PE100, D125/75, SDR11	KOM	HXF	60,54	456,07
PE10T125/90-16	T-RED. PE100, D125/90, SDR11	KOM	HXF	60,54	456,07
PE10T125/110-16	T-RED. PE100, D125/110, SDR11	KOM	HXF	60,54	456,07
PE10T140/63-16	T-RED. PE100, D140/63, SDR11	KOM	HXF	69,17	521,13
PE10T140/75-16	T-RED. PE100, D140/75, SDR11	KOM	HXF	69,17	521,13
PE10T140/90-16	T-RED. PE100, D140/90, SDR11	KOM	HXF	69,17	521,13
PE10T140/110-16	T-RED. PE100, D140/110, SDR11	KOM	HXF	69,17	521,13
PE10T140/125-16	T-RED. PE100, D140/125, SDR11	KOM	HXF	83,57	629,59
PE10T160/63-16	T-RED. PE100, D160/63, SDR11	KOM	HXF	84,82	639,03
PE10T160/75-16	T-RED. PE100, D160/75, SDR11	KOM	HXF	86,57	652,25
PE10T160/90-16	T-RED. PE100, D160/90, SDR11	KOM	HXF	88,33	665,48
PE10T160/110-16	T-RED. PE100, D160/110, SDR11	KOM	HXF	90,13	679,08
PE10T160/125-16	T-RED. PE100, D160/125, SDR11	KOM	HXF	114,78	864,74
PE10T160/140-16	T-RED. PE100, D160/140, SDR11	KOM	HXF	114,78	864,74
PE10T180/75-16	T-RED. PE100, D180/75, SDR11	KOM	HXF	128,92	971,30
PE10T180/90-16	T-RED. PE100, D180/90, SDR11	KOM	HXF	140,62	1.059,49
PE10T180/110-16	T-RED. PE100, D180/110, SDR11	KOM	HXF	140,62	1.059,49
PE10T180/125-16	T-RED. PE100, D180/125, SDR11	KOM	HXF	140,62	1.059,49
PE10T180/140-16	T-RED. PE100, D180/140, SDR11	KOM	HXF	140,62	1.059,49
PE10T180/160-16	T-RED. PE100, D180/160, SDR11	KOM	HXF	140,62	1.059,49
PE10T200/63-16	T-RED. PE100, D200/63, SDR11	KOM	HXF	154,00	1.160,26
PE10T200/75-16	T-RED. PE100, D200/75, SDR11	KOM	HXF	154,00	1.160,26
PE10T200/90-16	T-RED. PE100, D200/90, SDR11	KOM	HXF	169,80	1.279,35
PE10T200/110-16	T-RED. PE100, D200/110, SDR11	KOM	HXF	193,25	1.455,99
PE10T200/125-16	T-RED. PE100, D200/125, SDR11	KOM	HXF	193,25	1.455,99
PE10T200/140-16	T-RED. PE100, D200/140, SDR11	KOM	HXF	193,25	1.455,99
PE10T200/160-16	T-RED. PE100, D200/160, SDR11	KOM	HXF	193,25	1.455,99
PE10T200/180-16	T-RED. PE100, D200/180, SDR11	KOM	HXF	198,01	1.491,87
PE10T225/63-16	T-RED. PE100, D225/63, SDR11	KOM	HXF	290,03	2.185,17
PE10T225/75-16	T-RED. PE100, D225/75, SDR11	KOM	HXF	290,03	2.185,17
PE10T225/90-16	T-RED. PE100, D225/90, SDR11	KOM	HXF	290,03	2.185,17
PE10T225/110-16	T-RED. PE100, D225/110, SDR11	KOM	HXF	290,03	2.185,17
PE10T225/125-16	T-RED. PE100, D225/125, SDR11	KOM	HXF	290,03	2.185,17
PE10T225/160-16	T-RED. PE100, D225/160, SDR11	KOM	HXF	290,03	2.185,17
PE10T225/180-16	T-RED. PE100, D225/180, SDR11	KOM	HXF	290,03	2.185,17
PE10T225/200-16	T-RED. PE100, D225/200, SDR11	KOM	HXF	290,03	2.185,17



PE 100 SPOJNI ELEMENTI ZA PE CIJEVNE SUSTAVE

PE-T-KOMAD REDUCIRANI, SDR11



ŠIFRA	OPIS	JM	RAB	€/JM	KN/JM
PE10T250/90-16	T-RED. PE100, D250/90, SDR11	KOM	HXF	290,03	2.185,17
PE10T250/110-16	T-RED. PE100, D250/110, SDR11	KOM	HXF	437,14	3.293,62
PE10T250/160-16	T-RED. PE100, D250/160, SDR11	KOM	HXF	437,14	3.293,62
PE10T250/180-16	T-RED. PE100, D250/180, SDR11	KOM	HXF	437,14	3.293,62
PE10T250/200-16	T-RED. PE100, D250/200, SDR11	KOM	HXF	437,14	3.293,62
PE10T250/225-16	T-RED. PE100, D250/225, SDR11	KOM	HXF	437,14	3.293,62
PE10T280/110-16	T-RED. PE100, D280/110, SDR11	KOM	HXF	446,17	3.361,60
PE10T280/160-16	T-RED. PE100, D280/160, SDR11	KOM	HXF	446,17	3.361,60
PE10T280/200-16	T-RED. PE100, D280/200, SDR11	KOM	HXF	464,54	3.500,05
PE10T280/225-16	T-RED. PE100, D280/225, SDR11	KOM	HXF	474,06	3.571,75
PE10T280/250-16	T-RED. PE100, D280/250, SDR11	KOM	HXF	483,75	3.644,77
PE10T315/110-16	T-RED. PE100, D315/110, SDR11	KOM	HXF	496,54	3.741,14
PE10T315/160-16	T-RED. PE100, D315/160, SDR11	KOM	HXF	496,54	3.741,14
PE10T315/200-16	T-RED. PE100, D315/200, SDR11	KOM	HXF	496,54	3.741,14
PE10T315/225-16	T-RED. PE100, D315/225, SDR11	KOM	HXF	554,45	4.177,48
PE10T315/250-16	T-RED. PE100, D315/250, SDR11	KOM	HXF	554,45	4.177,48

PE-KAPA, SDR17



ŠIFRA	OPIS	JM	RAB	€/JM	KN/JM
PE10K50-10	KAPA PE100, D50, SDR17	KOM	HXF	5,53	41,62
PE10K63-10	KAPA PE100, D63, SDR17	KOM	HXF	7,38	55,56
PE10K75-10	KAPA PE100, D75, SDR17	KOM	HXF	12,19	91,82
PE10K90-10	KAPA PE100, D90, SDR17	KOM	HXF	14,84	111,75
PE10K110-10	KAPA PE100, D110, SDR17	KOM	HXF	19,07	143,61
PE10K125-10	KAPA PE100, D125, SDR17	KOM	HXF	22,13	166,70
PE10K140-10	KAPA PE100, D140, SDR17	KOM	HXF	27,57	207,67
PE10K160-10	KAPA PE100, D160, SDR17	KOM	HXF	28,78	216,80
PE10K180-10	KAPA PE100, D180, SDR17	KOM	HXF	40,79	307,31
PE10K200-10	KAPA PE100, D200, SDR17	KOM	HXF	50,71	382,00
PE10K225-10	KAPA PE100, D225, SDR17	KOM	HXF	60,64	456,88
PE10K250-10	KAPA PE100, D250, SDR17	KOM	HXF	90,38	680,90
PE10K280-10	KAPA PE100, D280, SDR17	KOM	HXF	157,12	1.183,82
PE10K315-10	KAPA PE100, D315, SDR17	KOM	HXF	215,20	1.621,40
PE10K355-10	KAPA PE100, D355, SDR17	KOM	HXF	419,03	3.157,13
PE10K400-10	KAPA PE100, D400, SDR17	KOM	HXF	739,46	5.571,45

PE-KAPA, SDR11



ŠIFRA	OPIS	JM	RAB	€/JM	KN/JM
PE10K20-16	KAPA PE100, D20, SDR11	KOM	HXF	2,55	19,16
PE10K25-16	KAPA PE100, D25, SDR11	KOM	HXF	2,74	20,57
PE10K32-16	KAPA PE100, D32, SDR11	KOM	HXF	3,29	24,78
PE10K40-16	KAPA PE100, D40, SDR11	KOM	HXF	4,01	30,18
PE10K50-16	KAPA PE100, D50, SDR11	KOM	HXF	5,61	42,21
PE10K63-16	KAPA PE100, D63, SDR11	KOM	HXF	7,59	57,16
PE10K75-16	KAPA PE100, D75, SDR11	KOM	HXF	12,92	97,32
PE10K90-16	KAPA PE100, D90, SDR11	KOM	HXF	16,28	122,62
PE10K110-16	KAPA PE100, D110, SDR11	KOM	HXF	21,11	159,00
PE10K125-16	KAPA PE100, D125, SDR11	KOM	HXF	24,14	181,81
PE10K140-16	KAPA PE100, D140, SDR11	KOM	HXF	30,17	227,26
PE10K160-16	KAPA PE100, D160, SDR11	KOM	HXF	31,79	239,45
PE10K180-16	KAPA PE100, D180, SDR11	KOM	HXF	43,24	325,75
PE10K200-16	KAPA PE100, D200, SDR11	KOM	HXF	53,68	404,39
PE10K225-16	KAPA PE100, D225, SDR11	KOM	HXF	66,01	497,35
PE10K250-16	KAPA PE100, D250, SDR11	KOM	HXF	94,64	713,03
PE10K280-16	KAPA PE100, D280, SDR11	KOM	HXF	157,12	1.183,82
PE10K315-16	KAPA PE100, D315, SDR11	KOM	HXF	215,20	1.621,40
PE10K355-16	KAPA PE100, D355, SDR11	KOM	HXF	419,03	3.157,13
PE10K400-16	KAPA PE100, D400, SDR11	KOM	HXF	739,46	5.571,45

PE-REDUKCIJA, SDR17

ŠIFRA	OPIS	JM	RAB	€/JM	KN/JM
PE10R90/63-10	RED. PE100, D90/63, SDR17	KOM	HXF	10,44	78,61
PE10R90/75-10	RED. PE100, D90/75, SDR17	KOM	HXF	10,44	78,61
PE10R110/63-10	RED. PE100, D110/63, SDR17	KOM	HXF	13,35	100,58



PE 100 SPOJNI ELEMENTI ZA PE CIJEVNE SUSTAVE

PE-REDUKCIJA, SDR17



ŠIFRA	OPIS	JM	RAB	€/JM	KN/JM
PE10R110/90-10	RED. PE100, D110/90, SDR17	KOM	HXF	13,35	100,58
PE10R125/63-10	RED. PE100, D125/63, SDR17	KOM	HXF	17,26	130,00
PE10R125/75-10	RED. PE100, D125/75, SDR17	KOM	HXF	17,26	130,00
PE10R125/90-10	RED. PE100, D125/90, SDR17	KOM	HXF	17,26	130,00
PE10R125/110-10	RED. PE100, D125/110, SDR17	KOM	HXF	17,26	130,00
PE10R140/75-10	RED. PE100, D140/75, SDR17	KOM	HXF	27,81	209,50
PE10R140/90-10	RED. PE100, D140/90, SDR17	KOM	HXF	27,81	209,50
PE10R140/110-10	RED. PE100, D140/110, SDR17	KOM	HXF	27,81	209,50
PE10R140/125-10	RED. PE100, D140/125, SDR17	KOM	HXF	27,81	209,50
PE10R160/90-10	RED. PE100, D160/90, SDR17	KOM	HXF	30,91	232,82
PE10R160/110-10	RED. PE100, D160/110, SDR17	KOM	HXF	30,91	232,82
PE10R160/125-10	RED. PE100, D160/125, SDR17	KOM	HXF	30,91	232,82
PE10R160/140-10	RED. PE100, D160/140, SDR17	KOM	HXF	30,91	232,82
PE10R180/90-10	RED. PE100, D180/90, SDR17	KOM	HXF	41,68	313,98
PE10R180/110-10	RED. PE100, D180/110, SDR17	KOM	HXF	41,68	313,98
PE10R180/125-10	RED. PE100, D180/125, SDR17	KOM	HXF	38,74	291,86
PE10R180/140-10	RED. PE100, D180/140, SDR17	KOM	HXF	45,26	340,98
PE10R180/160-10	RED. PE100, D180/160, SDR17	KOM	HXF	38,74	291,86
PE10R200/110-10	RED. PE100, D200/110, SDR17	KOM	HXF	42,82	322,59
PE10R200/125-10	RED. PE100, D200/125, SDR17	KOM	HXF	42,82	322,59
PE10R200/140-10	RED. PE100, D200/140, SDR17	KOM	HXF	52,68	396,88
PE10R200/160-10	RED. PE100, D200/160, SDR17	KOM	HXF	42,82	322,59
PE10R200/180-10	RED. PE100, D200/180, SDR17	KOM	HXF	50,14	377,73
PE10R225/110-10	RED. PE100, D225/110, SDR17	KOM	HXF	68,70	517,60
PE10R225/140-10	RED. PE100, D225/140, SDR17	KOM	HXF	84,60	637,37
PE10R225/160-10	RED. PE100, D225/160, SDR17	KOM	HXF	68,70	517,60
PE10R225/180-10	RED. PE100, D225/180, SDR17	KOM	HXF	68,70	517,60
PE10R225/200-10	RED. PE100, D225/200, SDR17	KOM	HXF	80,55	606,90
PE10R250/160-10	RED. PE100, D250/160, SDR17	KOM	HXF	111,55	840,47
PE10R250/180-10	RED. PE100, D250/180, SDR17	KOM	HXF	116,70	879,25
PE10R250/200-10	RED. PE100, D250/200, SDR17	KOM	HXF	116,70	879,25
PE10R250/225-10	RED. PE100, D250/225, SDR17	KOM	HXF	116,70	879,25
PE10R280/180-10	RED. PE100, D280/180, SDR17	KOM	HXF	146,58	1.104,36
PE10R280/200-10	RED. PE100, D280/200, SDR17	KOM	HXF	146,58	1.104,36
PE10R280/225-10	RED. PE100, D280/225, SDR17	KOM	HXF	146,58	1.104,36
PE10R280/250-10	RED. PE100, D280/250, SDR17	KOM	HXF	146,58	1.104,36
PE10R315/200-10	RED. PE100, D315/200, SDR17	KOM	HXF	191,17	1.440,35
PE10R315/225-10	RED. PE100, D315/225, SDR17	KOM	HXF	201,87	1.520,95
PE10R315/250-10	RED. PE100, D315/250, SDR17	KOM	HXF	201,87	1.520,95
PE10R315/280-10	RED. PE100, D315/280, SDR17	KOM	HXF	242,24	1.825,14
PE10R355/250-10	RED. PE100, D355/250, SDR17	KOM	HXF	341,64	2.574,02
PE10R355/280-10	RED. PE100, D355/280, SDR17	KOM	HXF	341,64	2.574,02
PE10R355/315-10	RED. PE100, D355/315, SDR17	KOM	HXF	341,64	2.574,02
PE10R400/280-10	RED. PE100, D400/280, SDR17	KOM	HXF	427,56	3.221,43
PE10R400/315-10	RED. PE100, D400/315, SDR17	KOM	HXF	427,56	3.221,43
PE10R400/355-10	RED. PE100, D400/355, SDR17	KOM	HXF	427,56	3.221,43

PE-REDUKCIJA, SDR11



ŠIFRA	OPIS	JM	RAB	€/JM	KN/JM
PE10R25/20-16	RED. PE100, D25/20, SDR11	KOM	HXF	2,32	17,42
PE10R32/20-16	RED. PE100, D32/20, SDR11	KOM	HXF	2,32	17,42
PE10R32/25-16	RED. PE100, D32/25, SDR11	KOM	HXF	2,32	17,42
PE10R40/20-16	RED. PE100, D40/20, SDR11	KOM	HXF	2,99	22,48
PE10R40/25-16	RED. PE100, D40/25, SDR11	KOM	HXF	3,39	25,49
PE10R40/32-16	RED. PE100, D40/32, SDR11	KOM	HXF	3,39	25,49
PE10R50/20-16	RED. PE100, D50/20, SDR11	KOM	HXF	3,96	29,79
PE10R50/25-16	RED. PE100, D50/25, SDR11	KOM	HXF	3,96	29,79
PE10R50/32-16	RED. PE100, D50/32, SDR11	KOM	HXF	3,66	27,57
PE10R50/40-16	RED. PE100, D50/40, SDR11	KOM	HXF	3,66	27,57
PE10R63/25-16	RED. PE100, D63/25, SDR11	KOM	HXF	4,70	35,40
PE10R63/32-16	RED. PE100, D63/32, SDR11	KOM	HXF	4,41	33,20
PE10R63/40-16	RED. PE100, D63/40, SDR11	KOM	HXF	4,41	33,20



PE 100 SPOJNI ELEMENTI ZA PE CIJEVNE SUSTAVE

PE-REDUKCIJA, SDR11



ŠIFRA	OPIS	JM	RAB	€/JM	KN/JM
PE10R63/50-16	RED. PE100, D63/50, SDR11	KOM	HXF	4,41	33,20
PE10R75/32-16	RED. PE100, D75/32, SDR11	KOM	HXF	7,27	54,76
PE10R75/40-16	RED. PE100, D75/40, SDR11	KOM	HXF	7,27	54,76
PE10R75/50-16	RED. PE100, D75/50, SDR11	KOM	HXF	7,27	54,76
PE10R75/63-16	RED. PE100, D75/63, SDR11	KOM	HXF	7,27	54,76
PE10R90/50-16	RED. PE100, D90/50, SDR11	KOM	HXF	11,02	82,98
PE10R90/63-16	RED. PE100, D90/63, SDR11	KOM	HXF	11,02	82,98
PE10R90/75-16	RED. PE100, D90/75, SDR11	KOM	HXF	11,02	82,98
PE10R110/50-16	RED. PE100, D110/50, SDR11	KOM	HXF	14,49	109,13
PE10R110/63-16	RED. PE100, D110/63, SDR11	KOM	HXF	14,49	109,13
PE10R110/75-16	RED. PE100, D110/75, SDR11	KOM	HXF	14,49	109,13
PE10R110/90-16	RED. PE100, D110/90, SDR11	KOM	HXF	14,49	109,13
PE10R125/63-16	RED. PE100, D125/63, SDR11	KOM	HXF	17,53	132,01
PE10R125/75-16	RED. PE100, D125/75, SDR11	KOM	HXF	17,53	132,01
PE10R125/90-16	RED. PE100, D125/90, SDR11	KOM	HXF	17,53	132,01
PE10R125/110-16	RED. PE100, D125/110, SDR11	KOM	HXF	17,53	132,01
PE10R140/75-16	RED. PE100, D140/75, SDR11	KOM	HXF	27,81	209,50
PE10R140/90-16	RED. PE100, D140/90, SDR11	KOM	HXF	27,81	209,50
PE10R140/110-16	RED. PE100, D140/110, SDR11	KOM	HXF	27,81	209,50
PE10R140/125-16	RED. PE100, D140/125, SDR11	KOM	HXF	27,81	209,50
PE10R160/90-16	RED. PE100, D160/90, SDR11	KOM	HXF	32,07	241,57
PE10R160/110-16	RED. PE100, D160/110, SDR11	KOM	HXF	32,07	241,57
PE10R160/125-16	RED. PE100, D160/125, SDR11	KOM	HXF	32,07	241,57
PE10R160/140-16	RED. PE100, D160/140, SDR11	KOM	HXF	32,07	241,57
PE10R180/90-16	RED. PE100, D180/90, SDR11	KOM	HXF	41,68	313,98
PE10R180/110-16	RED. PE100, D180/110, SDR11	KOM	HXF	41,68	313,98
PE10R180/125-16	RED. PE100, D180/125, SDR11	KOM	HXF	41,68	313,98
PE10R180/140-16	RED. PE100, D180/140, SDR11	KOM	HXF	41,68	313,98
PE10R180/160-16	RED. PE100, D180/160, SDR11	KOM	HXF	41,68	313,98
PE10R200/140-16	RED. PE100, D200/140, SDR11	KOM	HXF	48,65	366,50
PE10R200/160-16	RED. PE100, D200/160, SDR11	KOM	HXF	48,65	366,50
PE10R200/180-16	RED. PE100, D200/180, SDR11	KOM	HXF	48,65	366,50
PE10R225/110-16	RED. PE100, D225/110, SDR11	KOM	HXF	72,31	544,78
PE10R225/140-16	RED. PE100, D225/140, SDR11	KOM	HXF	84,60	637,37
PE10R225/160-16	RED. PE100, D225/160, SDR11	KOM	HXF	84,60	637,37
PE10R225/180-16	RED. PE100, D225/180, SDR11	KOM	HXF	84,60	637,37
PE10R225/200-16	RED. PE100, D225/200, SDR11	KOM	HXF	84,60	637,37
PE10R250/160-16	RED. PE100, D250/160, SDR11	KOM	HXF	124,56	938,48
PE10R250/180-16	RED. PE100, D250/180, SDR11	KOM	HXF	124,56	938,48
PE10R250/200-16	RED. PE100, D250/200, SDR11	KOM	HXF	124,56	938,48
PE10R250/225-16	RED. PE100, D250/225, SDR11	KOM	HXF	124,56	938,48
PE10R280/180-16	RED. PE100, D280/180, SDR11	KOM	HXF	154,82	1.166,46
PE10R280/200-16	RED. PE100, D280/200, SDR11	KOM	HXF	154,82	1.166,46
PE10R280/225-16	RED. PE100, D280/225, SDR11	KOM	HXF	154,82	1.166,46
PE10R280/250-16	RED. PE100, D280/250, SDR11	KOM	HXF	154,82	1.166,46
PE10R315/200-16	RED. PE100, D315/200, SDR11	KOM	HXF	250,01	1.883,66
PE10R315/225-16	RED. PE100, D315/225, SDR11	KOM	HXF	250,01	1.883,66
PE10R315/250-16	RED. PE100, D315/250, SDR11	KOM	HXF	250,01	1.883,66
PE10R315/280-16	RED. PE100, D315/280, SDR11	KOM	HXF	250,01	1.883,66
PE10R355/250-16	RED. PE100, D355/250, SDR11	KOM	HXF	423,07	3.187,55
PE10R355/280-16	RED. PE100, D355/280, SDR11	KOM	HXF	423,07	3.187,55
PE10R355/315-16	RED. PE100, D355/315, SDR11	KOM	HXF	423,07	3.187,55
PE10R400/280-16	RED. PE100, D400/280, SDR11	KOM	HXF	444,20	3.346,77
PE10R400/315-16	RED. PE100, D400/315, SDR11	KOM	HXF	444,20	3.346,77
PE10R400/355-16	RED. PE100, D400/355, SDR11	KOM	HXF	444,20	3.346,77

PE-TULJAK, SDR17

ŠIFRA	OPIS	JM	RAB	€/JM	KN/JM
PE10VB50-10	TULJAK PE100, D50, SDR17	KOM	HXF	2,25	16,89
PE10VB63-10	TULJAK PE100, D63, SDR17	KOM	HXF	2,71	20,38
PE10VB75-10	TULJAK PE100, D75, SDR17	KOM	HXF	3,40	25,61
PE10VB90-10	TULJAK PE100, D90, SDR17	KOM	HXF	9,16	68,97



PE 100 SPOJNI ELEMENTI ZA PE CIJEVNE SUSTAVE

PE-TULJAK, SDR17



ŠIFRA	OPIS	JM	RAB	€/JM	KN/JM
PE10VB110-10	TULJAK PE100, D110, SDR17	KOM	HXF	10,18	76,65
PE10VB125-10	TULJAK PE100, D125, SDR17	KOM	HXF	12,57	94,68
PE10VB140-10	TULJAK PE100, D140, SDR17	KOM	HXF	16,27	122,54
PE10VB160-10	TULJAK PE100, D160, SDR17	KOM	HXF	19,26	145,11
PE10VB180-10	TULJAK PE100, D180, SDR17	KOM	HXF	28,71	216,29
PE10VB200-10	TULJAK PE100, D200, SDR17	KOM	HXF	32,63	245,78
PE10VB225-10	TULJAK PE100, D225, SDR17	KOM	HXF	35,04	263,99
PE10VB250-10	TULJAK PE100, D250, SDR17	KOM	HXF	64,69	487,38
PE10VB280-10	TULJAK PE100, D280, SDR17	KOM	HXF	100,55	757,59
PE10VB315-10	TULJAK PE100, D315, SDR17	KOM	HXF	121,62	916,30
PE10VB355-10	TULJAK PE100, D355, SDR17	KOM	HXF	200,34	1.509,39
PE10VB400-10	TULJAK PE100, D400, SDR17	KOM	HXF	333,86	2.515,42
PE10VB450-10	TULJAK PE100, D450, SDR17	KOM	HXF	633,35	4.771,91
PE10VB500-10	TULJAK PE100, D500, SDR17	KOM	HXF	823,74	6.206,41
PE10VB560-10	TULJAK PE100, D560, SDR17	KOM	HXF	na upit	na upit
PE10VB630-10	TULJAK PE100, D630, SDR17	KOM	HXF	na upit	na upit

PE-TULJAK, SDR11



ŠIFRA	OPIS	JM	RAB	€/JM	KN/JM
PE10VB20-16	TULJAK PE100, D20, SDR11	KOM	HXF	2,50	18,82
PE10VB25-16	TULJAK PE100, D25, SDR11	KOM	HXF	2,62	19,71
PE10VB32-16	TULJAK PE100, D32, SDR11	KOM	HXF	2,99	22,46
PE10VB40-16	TULJAK PE100, D40, SDR11	KOM	HXF	3,67	27,64
PE10VB50-16	TULJAK PE100, D50, SDR11	KOM	HXF	4,44	33,41
PE10VB63-16	TULJAK PE100, D63, SDR11	KOM	HXF	5,51	41,44
PE10VB75-16	TULJAK PE100, D75, SDR11	KOM	HXF	7,23	54,41
PE10VB90-16	TULJAK PE100, D90, SDR11	KOM	HXF	9,16	68,97
PE10VB110-16	TULJAK PE100, D110, SDR11	KOM	HXF	10,97	82,62
PE10VB125-16	TULJAK PE100, D125, SDR11	KOM	HXF	13,79	103,86
PE10VB140-16	TULJAK PE100, D140, SDR11	KOM	HXF	17,74	133,64
PE10VB160-16	TULJAK PE100, D160, SDR11	KOM	HXF	20,32	153,06
PE10VB180-16	TULJAK PE100, D180, SDR11	KOM	HXF	30,98	233,35
PE10VB200-16	TULJAK PE100, D200, SDR11	KOM	HXF	35,07	264,17
PE10VB225-16	TULJAK PE100, D225, SDR11	KOM	HXF	41,12	309,75
PE10VB250-16	TULJAK PE100, D250, SDR11	KOM	HXF	76,11	573,38
PE10VB280-16	TULJAK PE100, D280, SDR11	KOM	HXF	100,55	757,59
PE10VB315-16	TULJAK PE100, D315, SDR11	KOM	HXF	121,62	916,30
PE10VB355-16	TULJAK PE100, D355, SDR11	KOM	HXF	200,34	1.509,39
PE10VB400-16	TULJAK PE100, D400, SDR11	KOM	HXF	333,86	2.515,42
PE10VB450-16	TULJAK PE100, D450, SDR11	KOM	HXF	682,12	5.139,38
PE10VB500-16	TULJAK PE100, D500, SDR11	KOM	HXF	904,79	6.817,13
PE10VB560-16	TULJAK PE100, D560, SDR11	KOM	HXF	na upit	na upit
PE10VB630-16	TULJAK PE100, D630, SDR11	KOM	HXF	na upit	na upit

PE-SLOBODNA PRIRUBNICA SA METALNOM JEZGROM, DN20-DN180 PN16, >DN180 PN10 BUŠENJA PREMA ISO 7005, EN 1092, DIN 2501



ŠIFRA	OPIS	JM	RAB	€/JM	KN/JM
PP-LOSF20-10	SL. PRIRUBNICA PP-M, D20, PN16	KOM	HXF	6,69	50,40
PP-LOSF25-10	SL. PRIRUBNICA PP-M, D25, PN16	KOM	HXF	5,91	44,52
PP-LOSF32-10	SL. PRIRUBNICA PP-M, D32, PN16	KOM	HXF	7,37	55,50
PP-LOSF40-10	SL. PRIRUBNICA PP-M, D40, PN16	KOM	HXF	8,78	66,13
PP-LOSF50-10	SL. PRIRUBNICA PP-M, D50, PN16	KOM	HXF	10,44	78,60
PP-LOSF63-10	SL. PRIRUBNICA PP-M, D63, PN16	KOM	HXF	13,80	103,93
PP-LOSF75-10	SL. PRIRUBNICA PP-M, D75, PN16	KOM	HXF	15,58	117,34
PP-LOSF90-10	SL. PRIRUBNICA PP-M, D90, PN16	KOM	HXF	18,52	139,50
PP-LOSF110-10	SL. PRIRUBNICA PP-M, D110, PN16	KOM	HXF	24,13	181,79
PP-LOSF125-10	SL. PRIRUBNICA PP-M, D125, PN16	KOM	HXF	24,13	181,79
PP-LOSF140-10	SL. PRIRUBNICA PP-M, D140, PN16	KOM	HXF	30,81	232,07
PP-LOSF160-10	SL. PRIRUBNICA PP-M, D160, PN16	KOM	HXF	39,75	299,49
PP-LOSF180-10	SL. PRIRUBNICA PP-M, D180, PN16	KOM	HXF	39,75	299,49
PP-LOSF200-10	SL. PRIRUBNICA PP-M, D200, PN10	KOM	HXF	57,31	431,73
PP-LOSF225-10	SL. PRIRUBNICA PP-M, D225, PN10	KOM	HXF	57,31	431,73
PP-LOSF250-10	SL. PRIRUBNICA PP-M, D250, PN10	KOM	HXF	72,93	549,44



PE 100 SPOJNI ELEMENTI ZA PE CIJEVNE SUSTAVE

PE-SLOBODNA PRIRUBNICA SA METALNOM JEZGROM, DN20-DN180 PN16, >DN180 PN10

BUŠENJA PREMA ISO 7005, EN 1092, DIN 2501



ŠIFRA	OPIS	JM	RAB	€/JM	KN/JM
PP-LOSF280-10	SL. PRIRUBNICA PP-M, D280, PN10	KOM	HXF	72,93	549,44
PP-LOSF315-10	SL. PRIRUBNICA PP-M, D315, PN10	KOM	HXF	115,35	869,04
PP-LOSF355-10	SL. PRIRUBNICA PP-M, D355, PN10	KOM	HXF	227,90	1.717,04
PP-LOSF400-10	SL. PRIRUBNICA PP-M, D400, PN10	KOM	HXF	265,87	2.003,13
PP-LOSF450-10	SL. PRIRUBNICA PP-M, D450, PN10	KOM	HXF	403,96	3.043,61
PP-LOSF500-10	SL. PRIRUBNICA PP-M, D500, PN10	KOM	HXF	403,96	3.043,61
PP-LOSF560-10	SL. PRIRUBNICA PP-M, D560, PN10	KOM	HXF	na upit	na upit
PP-LOSF630-10	SL. PRIRUBNICA PP-M, D630, PN10	KOM	HXF	na upit	na upit

PE-SLOBODNA PRIRUBNICA SA METALNOM JEZGROM, PN16

BUŠENJA PREMA ISO 7005, EN 1092, DIN 2501



ŠIFRA	OPIS	JM	RAB	€/JM	KN/JM
PP-LOSF200-16	SL. PRIRUBNICA PP-M, D200, PN16	KOM	HXF	87,28	657,56
PP-LOSF225-16	SL. PRIRUBNICA PP-M, D225, PN16	KOM	HXF	87,28	657,56
PP-LOSF250-16	SL. PRIRUBNICA PP-M, D250, PN16	KOM	HXF	118,63	893,81
PP-LOSF280-16	SL. PRIRUBNICA PP-M, D280, PN16	KOM	HXF	118,63	893,81
PP-LOSF315-16	SL. PRIRUBNICA PP-M, D315, PN16	KOM	HXF	181,29	1.365,88
PP-LOSF355-16	SL. PRIRUBNICA PP-M, D355, PN16	KOM	HXF	342,93	2.583,75
PP-LOSF400-16	SL. PRIRUBNICA PP-M, D400, PN16	KOM	HXF	390,29	2.940,59

DETEKTIBILNE TRAKE & TRAKE UPOZORENJA



ŠIFRA	OPIS	JM	RAB	€/JM	KN/JM
TRAKAOV	TRAKA POZOR VODOVOD, 250M	M	HXF	0,07	0,48
TRAKADV	DET. TRAKA POZOR VODOVOD,250M	M	HXF	0,39	2,88
TRAKAOP	TRAKA POZOR PLINOVOD, 250M	M	HXF	0,07	0,48
TRAKADP	DET. TRAKA POZOR PLINOVOD,250M	M	HXF	0,39	2,88